



NEGATIVE DECLARATION

Project Title/File Number: SVSP PCL KT-43 – Baseline Storage; File # PL19-0350
Project Location: 5750 Baseline Road, Roseville, Placer County; APN 499-010-082
Project Applicant: Dave Stark, Stark Designs; (916) 390-2236; 2411 Saint Andrews Drive, Rocklin, CA 95765
Property Owner: KV Sierra Vista LLC; 601 University Ave. Ste. 125, Sacramento, CA 95825
Lead Agency Contact Person: Charity Gold, Associate Planner - City of Roseville; (916) 774-5247
Date: October 15, 2020

Project Description:

The project includes a Conditional Use Permit and a Design Review Permit to construct an approximately 230,000 square foot self-storage facility that will consist of a 1,364 square foot office, a 1,452 square foot manager's residence, 226,149 square feet of storage.

DECLARATION

The Planning Manager has determined that the above project will not have significant effects on the environment and therefore does not require preparation of an Environmental Impact Report. The determination is based on the attached initial study and the following findings:

- A. *The project will not have the potential to degrade the quality of the environment, substantially reduce the habitat of fish or wildlife species, cause a fish or wildlife population to drop below self sustaining levels, threaten to eliminate a plant or animal community, substantially reduce the number or restrict the range of an endangered, rare or threatened species, reduce the number or restrict the range of rare or endangered plants or animals or eliminate important examples of the major periods of California history or prehistory.*
- B. *The project will not have the potential to achieve short-term, to the disadvantage of long-term, environmental goals.*
- C. *The project will not have impacts, which are individually limited, but cumulatively considerable.*
- D. *The project will not have environmental effects, which will cause substantial adverse effects on human beings, either directly or indirectly.*
- E. *No substantial evidence exists that the project may have a significant effect on the environment.*



INITIAL STUDY & ENVIRONMENTAL CHECKLIST

Project Title/File Number:	SVSP PCL KT-43 – Baseline Storage/PL19-0350
Project Location:	5750 Baseline Road
Project Description:	The project includes a Conditional Use Permit and a Design Review Permit to construct an approximately 230,000 square foot self-storage facility that will consist of a 1,364 square foot office, a 1,452 square foot manager's residence, 226,149 square feet of storage.
Project Applicant:	Dave Stark, Stark Designs
Property Owner:	KV Sierra Vista, LLC
Lead Agency Contact:	Charity Gold, Associate Planner

This initial study has been prepared to identify and assess the anticipated environmental impacts of the above described project application. The document relies on the previously prepared environmental document for the Sierra Vista Specific Plan and site-specific studies prepared to address in detail the effects or impacts associated with the project (see Attachments). Where documents were submitted by consultants working for the applicant, City staff reviewed such documents in order to determine whether, based on their own professional judgment and expertise, staff found such documents to be credible and persuasive. Staff has only relied on documents that reflect their independent judgment, and has not accepted at face value representations made by consultants for the applicant.

This document has been prepared to satisfy the California Environmental Quality Act (CEQA), (Public Resources Code, Section 21000 et seq.) and the State CEQA Guidelines (14 CCR 15000 et seq.). CEQA requires that all state and local government agencies consider the environmental consequences of projects over which they have discretionary authority before acting on those projects.

The initial study is a public document used by the decision-making lead agency to determine whether a project may have a significant effect on the environment. If the lead agency finds substantial evidence that any aspect of the project, either individually or cumulatively, may have a significant effect on the environment, regardless of whether the overall effect of the project is adverse or beneficial, the lead agency is required to prepare an EIR. If the agency finds no substantial evidence that the project or any of its aspects may cause a significant effect on the environment, a negative declaration shall be prepared. If in the course of analysis, the agency recognizes that the project may have a significant impact on the environment, but that by incorporating specific mitigation measures to which the applicant agrees, the impact will be reduced to a less than significant effect, a mitigated negative declaration shall be prepared.

PC Exhibit A

INITIAL STUDY

October 15, 2020

SVSP PCL KT-43 – Baseline Storage – 5750 Baseline Road

File # PL19-0350

Page 2 of 44

Table of Contents

Project Description	3
City of Roseville Mitigation Ordinances, Guidelines, and Standards	5
Other Environmental Documents Relied Upon	6
Explanation of Initial Study Checklist	6
Initial Study Checklist	
I. Aesthetics	7
II. Agricultural & Forestry Resources	9
III. Air Quality	10
IV. Biological Resources	13
V. Cultural Resources	16
VI. Energy	18
VII. Geology and Soils	19
VIII. Greenhouse Gases	21
IX. Hazards and Hazardous Materials	23
X. Hydrology and Water Quality	26
XI. Land Use and Planning	29
XII. Mineral Resources	29
XIII. Noise	30
XIV. Population and Housing	32
XV. Public Services	33
XVI. Recreation	35
XVII. Transportation / Traffic	35
XVIII. Tribal Cultural Resources	38
XIX. Utilities and Service Systems	39
XX. Wildfire	41
XXI. Mandatory Findings of Significance	42
Environmental Determination	44
Attachments	44

PROJECT DESCRIPTION

Project Location

The project site is located on the north side of Baseline Road approximately one mile west of the intersection of Fiddlyment Road and Baseline Road and within the Sierra Vista Specific Plan (SVSP) area (Figure 1).

Background

An Environmental Impact Report (EIR) was certified (SCH #2008032115) and a Mitigation Monitoring and Reporting Program was adopted for the SVSP project (File 2007PL-044) on May 5, 2010. The SVSP plan area includes 2,064 acres located west of Fiddlyment Road and north of Baseline Road. The SVSP sets the framework for development of the plan area with a mix of residential, commercial, parks, and open space land uses.

On December 23, 2019, a Tentative Parcel Map was approved to divide Parcel KT-43 (11.97 acres) into two parcels, KT-43a (1.97 acres) and KT-43b (10 acres). The proposed project is located on the resulting 10-acre parcel (KT-43b).

Figure 1: Project Location



Location	Zoning	General Plan Land Use	Actual Use of Property
Site	CC/SA	CC	Vacant
North	RS/DS	LDR-5.9	Vacant
South	SPL-PVSP	Placer Vineyards Specific Plan	Vacant / Dry Farm
East	RD/DS and OS	LDR-4.8 and OS	Vacant and Open Space
West	GC	CC	Vacant

Environmental Setting

The project is located on a vacant property on the north side of Baseline Road within a developing portion of the City of Roseville. Topography of the site is relatively flat. The site has been heavily disturbed from previous grading and site preparation for adjacent development. Currently, there are no trees or other biological resources on the site. The current land use and zoning of the site allow for commercial and business professional uses. The site is surrounded by vacant properties that are planned for residential and commercial development as well and an existing open space parcel. A new subdivision is currently under construction adjacent to the project's northern boundary.

PC Exhibit A

INITIAL STUDY

October 15, 2020

SVSP PCL KT-43 – Baseline Storage – 5750 Baseline Road

File # PL19-0350

Page 4 of 44

Proposed Project

The project includes a Conditional Use Permit and Design Review Permit for an approximately 230,000 square foot self-storage facility (Figure 2). The facility will offer a variety of storage sizes ranging from 5 x 5 to 10 x 40, with a portion of them to include climate control. The facility will include a 1,364 square foot office with hours of operation between 8:00 am and 6:00 pm, a 1,452 square foot onsite manager's residence, and 226,149 square feet of storage buildings. The project will be built in phases with the first phase to include 50,000 to 100,000 square feet of rentable space and 94 RV/Boat parking stalls. The remainder of the site will be built in the second phase with the RV/Boat storage spaces replaced with storage buildings. The analyses that follow assume full buildout of the project.

The interior of the site will be lighted with the exterior fencing to include a combination of masonry walls and open fencing. The site will be gated with access granted between the hours of 7:00 am and 7:00 pm Monday through Friday and 8:00 am to 8:00 pm Saturday, Sunday, and holidays.

Figure 2: Master Site Plan

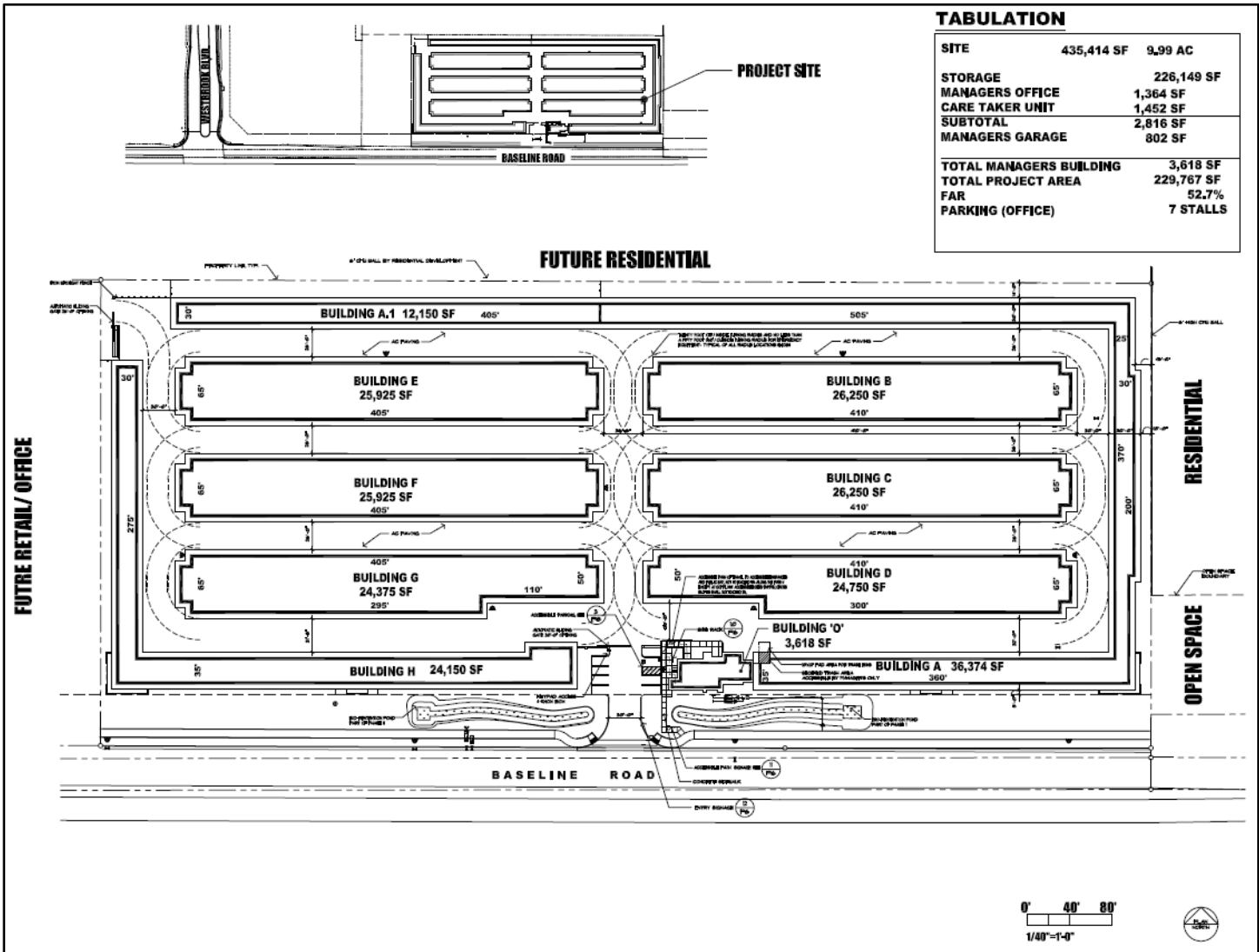

CITY OF ROSEVILLE MITIGATION ORDINANCES, GUIDELINES, AND STANDARDS

For projects that are consistent with the development density established by existing zoning, community plan, or general plan policies for which an EIR was certified, CEQA Guidelines section 15183(f) allows a lead agency to rely on previously adopted development policies or standards as mitigation for the environmental effects, when the standards have been adopted by the City, with findings based on substantial evidence, that the policies or standards will substantially mitigate environmental effects, unless substantial new information shows otherwise (CEQA Guidelines §15183(f)). The City of Roseville adopted CEQA Implementing Procedures (Implementing Procedures) which are consistent with this CEQA Guidelines section. The current version of the Implementing Procedures were adopted in April 2008, along with Findings of Fact, as Resolution 08-172. The below regulations and ordinances were found to provide uniform mitigating policies and standards, and are applicable to development projects. The City's Mitigating Policies and Standards are referenced, where applicable, in the Initial Study Checklist.

- City of Roseville 2035 General Plan (Amended August 2020)
- City of Roseville Zoning Ordinance (RMC Title 19)
- City of Roseville Design and Construction Standards (Resolution 16-75)
- Subdivision Ordinance (RMC Title 18)
- Noise Regulation (RMC Ch.9.24)
- Flood Damage Prevention Ordinance (RMC Ch.9.80)
- Drainage Fees (Dry Creek [RMC Ch.4.49] and Pleasant Grove Creek [RMC Ch.4.48])
- West Placer Stormwater Quality Design Manual (Resolution 16-152)
- Urban Stormwater Quality Management and Discharge Control Ordinance (RMC Ch. 14.20)
- Traffic Mitigation Fee (RMC Ch.4.44)
- Highway 65 Joint Powers Authority Improvement Fee (Resolution 2008-02)
- South Placer Regional Transportation Authority Transportation and Air Quality Mitigation Fee (Resolution 09-05)
- Tree Preservation Ordinance (RMC Ch.19.66)
- Community Design Guidelines (Resolution 95-347)
- Specific Plan Design Guidelines:
 - Development Guidelines Del Webb Specific Plan (Resolution 96-330)
 - Landscape Design Guidelines for North Central Roseville Specific Plan (Resolution 90-170)
 - North Roseville Specific Plan and Design Guidelines (Resolution 00-432)
 - Northeast Roseville Specific Plan (Olympus Pointe) Signage Guidelines (Resolution 89-42)
 - North Roseville Area Design Guidelines (Resolution 92-226)
 - Northeast Roseville Specific Plan Landscape Design Guidelines (Resolution 87-31)
 - Southeast Roseville Specific Plan Landscape Design Guidelines (Resolution 88-51)
 - Stoneridge Specific Plan and Design Guidelines (Resolution 98-53)
 - Highland Reserve North Specific Plan and Design Guidelines (Resolution 97-128)
 - West Roseville Specific Plan and Design Guidelines (Resolution 04-40)
 - Sierra Vista Specific Plan and Design Guidelines (Resolution 12-217)
 - Creekview Specific Plan and Design Guidelines (Resolution 12-320)
 - Amoruso Ranch Specific Plan and Design Guidelines (Resolution 16-273)

OTHER ENVIRONMENTAL DOCUMENTS RELIED UPON

- City of Roseville 3035 General Plan Update Environmental Impact Report
- Amoruso Ranch Specific Plan Final Environmental Impact Report
- Sierra Vista Specific Plan Final Environmental Impact Report

Pursuant to CEQA Guidelines Section 15183, any project that is consistent with the development densities established by zoning, a Community Plan, or a General Plan for which an EIR was certified shall not require additional environmental review, except as may be necessary to examine whether there are project-specific significant effects which are peculiar to the project or its site. The Amoruso Ranch Specific Plan EIR updated the City's General Plan to 2035, and updated Citywide analyses of traffic, water supply, water treatment, wastewater treatment, and waste disposal. The proposed project is consistent with the adopted land use designations examined within the environmental documents listed above, and thus this Initial Study focuses on effects particular to the specific project site, impacts which were not analyzed within the EIR, and impacts which may require revisiting due to substantial new information. When applicable, the topical sections within the Initial Study summarize the findings within the environmental documents listed above. The analysis, supporting technical materials, and findings of the environmental document are incorporated by reference, and are available for review at the Civic Center, 311 Vernon Street, Roseville, CA.

EXPLANATION OF INITIAL STUDY CHECKLIST

The California Environmental Quality Act (CEQA) Guidelines recommend that lead agencies use an Initial Study Checklist to determine potential impacts of the proposed project on the physical environment. The Initial Study Checklist provides a list of questions concerning a comprehensive array of environmental issue areas potentially affected by this project. This section of the Initial Study incorporates a portion of Appendix G Environmental Checklist Form, contained in the CEQA Guidelines. Within each topical section (e.g. Air Quality) a description of the setting is provided, followed by the checklist responses, thresholds used, and finally a discussion of each checklist answer.

There are four (4) possible answers to the Environmental Impacts Checklist on the following pages. Each possible answer is explained below:

- 1) A "Potentially Significant Impact" is appropriate if there is enough relevant information and reasonable inferences from the information that a fair argument based on substantial evidence can be made to support a conclusion that a substantial, or potentially substantial, adverse change may occur to any of the physical conditions within the area affected by the project. When one or more "Potentially significant Impact" entries are made, an EIR is required.
- 2) A "Less Than Significant With Mitigation" answer is appropriate when the lead agency incorporates mitigation measures to reduce an impact from "Potentially Significant" to "Less than Significant." For example, floodwater impacts could be reduced from a potentially-significant level to a less-than-significant level by relocating a building to an area outside of the floodway. The lead agency must describe the mitigation measures, and briefly explain how they reduce the effect to a less-than-significant level. Mitigation measures are identified as MM followed by a number.
- 3) A "Less Than significant Impact" answer is appropriate if there is evidence that one or more environmental impacts may occur, but the impacts are determined to be less than significant, or the application of development policies and standards to the project will reduce the impact(s) to a less-than-significant

PC Exhibit A

INITIAL STUDY

October 15, 2020

SVSP PCL KT-43 – Baseline Storage – 5750 Baseline Road

File # PL19-0350

Page 7 of 44

level. For instance, the application of the City's Improvement Standards reduces potential erosion impacts to a less-than-significant level.

- 4) A "No Impact" answer is appropriate where it can be demonstrated that the impact does not have the potential to adversely affect the environment. For instance, a project in the center of an urbanized area with no agricultural lands on or adjacent to the project area clearly would not have an adverse effect on agricultural resources or operations. A brief explanation is required for all answers except "No Impact" answers that are adequately supported by the information sources cited in the Initial Study. Where a "No Impact" answer is adequately supported by the information sources cited in the Initial Study, further narrative explanation is not required. A "No Impact" answer is explained when it is based on project-specific factors as well as generous standards.

All answers must take account of the whole action involved, including off- and on-site, indirect, direct, construction, and operation impacts, except as provided for under State CEQA Guidelines.

INITIAL STUDY CHECKLIST

I. Aesthetics

The project is located on a vacant property within a developing portion of the City. Properties adjacent to the project site to the north and east are developing with single-family uses. To the west of the project site, the property is expected to develop with commercial uses. The properties south of the project are planned for developed with a current agricultural use. There are no scenic vistas or scenic resources within the vicinity of the project.

Would the project:

Environmental Issue	Potentially Significant Impact	Less Than Significant With Mitigation	Less Than Significant Impact	No Impact
a) Have a substantial adverse effect on a scenic vista?				X
b) Substantially damage scenic resources, including, but not limited to, trees, rock outcroppings, and historic buildings within a state scenic highway?				X

PC Exhibit A

INITIAL STUDY

October 15, 2020

SVSP PCL KT-43 – Baseline Storage – 5750 Baseline Road

File # PL19-0350

Page 8 of 44

Environmental Issue	Potentially Significant Impact	Less Than Significant With Mitigation	Less Than Significant Impact	No Impact
c) In non-urbanized area, substantially degrade the existing visual character or quality of public views of the site and its surroundings? (Public views are those that are experienced from a publicly accessible vantage point.) If the project is in an urbanized area, would the project conflict with applicable zoning and other regulations governing scenic quality?			X	
d) Create a new source of substantial light or glare, which would adversely affect day or nighttime views in the area?			X	

Thresholds of Significance and Regulatory Setting:

The significance of an environmental impact cannot always be determined through the use of a specific, quantifiable threshold. CEQA Guidelines Section 15064(b) affirms this by the statement “an ironclad definition of significant effect is not always possible because the significance of an activity may vary with the setting.” This is particularly true of aesthetic impacts. As an example, a proposed parking lot in a dense urban center would have markedly different visual effects than a parking lot in an open space area. For the purpose of this study, the significance thresholds are as stated in CEQA Guidelines Appendix G, as shown in a–d of the checklist below. The Findings of the Implementing Procedures indicate that compliance with the Zoning Ordinance (e.g. building height, setbacks, etc), Subdivision Ordinance (RMC Ch. 18), Community Design Guidelines (Resolution 95-347), and applicable Specific Plan Policies and/or Specific Plan Design Guidelines will prevent significant impacts in urban settings as it relates to items a, b, and c, below.

Discussion of Checklist Answers:

a–b) There are no designated or eligible scenic vistas or scenic highways within or adjacent to the City of Roseville.

c) The project site is in an urban setting, and as a result lacks any prominent or high-quality natural features which could be negatively impacted by development. The City of Roseville has adopted Community Design Guidelines (CDG) for the purpose of creating building and community designs which are a visual asset to the community. The CDG includes guidelines for building design, site design and landscape design, which will result in a project that enhances the existing urban visual environment. Accordingly, the aesthetic impacts of the project are less than significant.

d) The project involves nighttime lighting to provide for the security and safety of project users. However, the project is already located within an urbanized setting with many existing lighting sources. Lighting is conditioned to comply with City standards (i.e. CDG) to limit the height of light standards and to require cut-off lenses and glare

PC Exhibit A

INITIAL STUDY

October 15, 2020

SVSP PCL KT-43 – Baseline Storage – 5750 Baseline Road

File # PL19-0350

Page 9 of 44

shields to minimize light and glare impacts. The project will not create a new source of substantial light. None of the project elements are highly reflective, and thus the project will not contribute to an increased source of glare.

II. Agricultural & Forestry Resources

The State Department of Conservation oversees the Farmland Mapping and Monitoring Program, which was established to document the location, quality, and quantity of agricultural lands, and the conversion of those lands over time. The primary land use classifications on the maps generated through this program are: Urban and Built Up Land, Grazing Land, Farmland of Local Importance, Unique Farmland, Farmland of Statewide Importance, and Prime Farmland. According to the current California Department of Conservation Placer County Important Farmland Map (2012), the majority of the City of Roseville is designated as Urban and Built Up Land and most of the open space areas of the City are designated as Grazing Land. There are a few areas designated as Farmland of Local Importance and two small areas designated as Unique Farmland located on the western side of the City along Baseline Road. The current Williamson Act Contract map (2013/2014) produced by the Department of Conservation shows that there are no Williamson Act contracts within the City, and only one (on PFE Road) that is adjacent to the City. None of the land within the City is considered forest land by the Board of Forestry and Fire Protection.

Would the project:

Environmental Issue	Potentially Significant Impact	Less Than Significant With Mitigation	Less Than Significant Impact	No Impact
a) Convert Prime Farmland, Unique Farmland, or Farmland of Statewide Importance (Farmland), as shown on the maps prepared pursuant to the Farmland Mapping and Monitoring Program of the California Resources Agency, to non-agricultural use?				X
b) Conflict with existing zoning for agricultural use, or a Williamson Act contract?				X
c) Conflict with existing zoning for, or cause rezoning of, forest land (as defined in Public Resources Code section 12220(g)), timberland (as defined by Public Resources Code section 4526), or timberland zoned Timberland Production (as defined by Government Code section 51104(g))?				X

PC Exhibit A

INITIAL STUDY

October 15, 2020

SVSP PCL KT-43 – Baseline Storage – 5750 Baseline Road

File # PL19-0350

Page 10 of 44

Environmental Issue	Potentially Significant Impact	Less Than Significant With Mitigation	Less Than Significant Impact	No Impact
d) Result in the loss of forest land or conversion of forest land to non-forest use?				X
e) Involve other changes in the existing environment which, due to their location or nature, could result in conversion of Farmland, to non-agricultural use or conversion of forest land to non-forest use?				X

Thresholds of Significance and Regulatory Setting:

Unique Farmland, Farmland of Statewide Importance, and Prime Farmland are called out as protected farmland categories within CEQA Guidelines Appendix G. Neither the City nor the State has adopted quantified significance thresholds related to impacts to protected farmland categories or to agricultural and forestry resources. For the purpose of this study, the significance thresholds are as stated in CEQA Guidelines Appendix G, as shown in a–e of the checklist above.

Discussion of Checklist Answers:

a–e) The project site is not used for agricultural purposes, does not include agricultural zoning, is not within or adjacent to one of the areas of the City designated as a protected farmland category on the Placer County Important Farmland map, is not within or adjacent to land within a Williamson Act Contract, and is not considered forest land. Given the foregoing, the proposed project will have no impact on agricultural resources.

III. Air Quality

The City of Roseville, along with the south Placer County area, is located in the Sacramento Valley Air Basin (SVAB). The SVAB is within the Sacramento Federal Ozone Non-Attainment Area. Under the Clean Air Act, Placer County has been designated a "serious non-attainment" area for the federal 8-hour ozone standard, "non-attainment" for the state ozone standard, and a "non-attainment" area for the federal and state PM₁₀ standard (particulate matter less than 10 microns in diameter). Within Placer County, the Placer County Air Pollution Control District (PCAPCD) is responsible for ensuring that emission standards are not violated. Would the project:

Environmental Issue	Potentially Significant Impact	Less Than Significant With Mitigation	Less Than Significant Impact	No Impact
a) Conflict with or obstruct implementation of the applicable air quality plan?				X

PC Exhibit A

INITIAL STUDY

October 15, 2020

SVSP PCL KT-43 – Baseline Storage – 5750 Baseline Road

File # PL19-0350

Page 11 of 44

Environmental Issue	Potentially Significant Impact	Less Than Significant With Mitigation	Less Than Significant Impact	No Impact
b) Result in a cumulatively considerable net increase of any criteria for which the project region is non-attainment under an applicable federal or state ambient air quality standard?				X
c) Expose sensitive receptors to substantial pollutant concentrations?				X
d) Result in other emissions (such as those leading to odors) adversely affecting a substantial number of people?				X

Thresholds of Significance and Regulatory Setting:

In responding to checklist items a–c, project-related air emissions would have a significant effect if they would result in concentrations that either violate an ambient air quality standard or contribute to an existing air quality violation. To assist in making this determination, the PCAPCD adopted thresholds of significance, which were developed by considering both the health-based ambient air quality standards and the attainment strategies outlined in the State Implementation Plan. The PCAPCD-recommended significance threshold for reactive organic gases (ROG) and nitrogen oxides (NO_x) is 82 pounds daily during construction and 55 pounds daily during operation, and for particulate matter (PM) is 82 pounds per day during both construction and operation. For all other constituents, significance is determined based on the concentration-based limits in the Federal and State Ambient Air Quality Standards. Toxic Air Contaminants (TAC) are also of public health concern, but no thresholds or standards are provided because they are considered to have no safe level of exposure. Analysis of TAC is based on the *Air Quality and Land Use Handbook – A Community Health Perspective* (April 2005, California Air Resources Board), which lists TAC sources and recommended buffer distances from sensitive uses. For checklist item c, the PCAPCD’s *CEQA Air Quality Handbook (Handbook)* recommends that the same thresholds used for the project analysis be used for the cumulative impact analysis.

With regard to checklist item d, there are no quantified significance thresholds for exposure to objectionable odors or other emissions. Significance is determined after taking into account multiple factors, including screening distances from odor sources (as found in the PCAPCD CEQA Handbook), the direction and frequency of prevailing winds, the time of day when emissions are detectable/present, and the nature and intensity of the emission source.

Discussion of Checklist Answers:

a–c) Analyses are not included for sulfur dioxide, lead, and other constituents because there are no mass emission thresholds; these are concentration-based limits in the Federal and State Ambient Air Quality Standards which require substantial, point-source emissions (e.g. refineries, concrete plants, etc) before exceedance will occur, and the SVAB is in attainment for these constituents. Likewise, carbon monoxide is not analyzed because the SVAB is in attainment for this constituent, and it requires high localized concentrations (called carbon monoxide “hot spots”) before the ambient air quality standard would be exceeded. “Hot spots” are typically associated with heavy traffic congestion occurring at high-volume roadway intersections. The

PC Exhibit A

INITIAL STUDY

October 15, 2020

SVSP PCL KT-43 – Baseline Storage – 5750 Baseline Road

File # PL19-0350

Page 12 of 44

Amoruso Ranch EIR analysis of Citywide traffic indicated that 198 out of 226 signalized intersections would operate at level of service C or better—that is, they will not experience heavy traffic congestion. It further indicated that analyses of existing CO concentrations at the most congested intersections in Roseville show that CO levels are well below federal and state ambient air quality standards. The discussions below focus on emissions of ROG, NO_x, or PM. A project-level analysis has been prepared to determine whether the project will, on a singular level, exceed the established thresholds.

Clearing, grading, and construction activities on the 5.24-acre site will result in emissions of criteria pollutants for which the area is in non-attainment. The PCAPCD recommends that lead agencies use the California Emissions Estimator Model (CalEEMod) to quantify a project's construction and operational emissions for criterial air pollutants (NO_x, ROG, and PM). The results are then compared to the significance thresholds established by the district, as detailed above. According to PCAPCD's published screening table, general commercial projects smaller than 249,099 square feet will not result in NO_x emissions that exceed 55 lbs/day. Typically, NO_x emissions are substantially higher than ROG and PM₁₀; therefore, it can be assumed that projects that do not exceed the NO_x threshold will not exceed the ROG and PM₁₀ thresholds, and will not result in a significant impact related to operational emissions.

The project proposes the construction of an approximately 230,000 square-foot storage facility consisting of a manager's residence, office building, and storage units. The project's combined square footage is below PCAPCD's modeled example. Given its small size, the project is not expected to result in construction or operational emissions that would exceed the district's thresholds for significance. To substantiate this assumption, the proposed project's emissions were modeled using the default construction and operational assumptions in CalEEMod version 2016.3.1 (Attachment 1). The modeled emissions for the project do not exceed the construction and operational thresholds of significance (Table 1).

Table 1: CalEEMod Results

Pollutant	Project Emissions (lbs/day)	Significance Threshold (lbs/day)	Exceeds Threshold?
Construction Emissions			
ROG	33.61	82	No
NO _x	42.46	82	No
PM ₁₀	20.41	82	No
Operational Emissions			
ROG	2.64	55	No
NO _x	5.79	55	No
PM ₁₀	2.97	82	No

The proposed project would not exceed the applicable thresholds of significance for air pollutant emissions during construction or operation. The project would not conflict with or obstruct implementation of the *Sacramento Regional 8-Hour Ozone Attainment and Reasonable Further Progress Plan* (which is the SIP) or contribute substantially to the PCAPCD's nonattainment status for ozone. In addition, because the proposed

PC Exhibit A

INITIAL STUDY

October 15, 2020

SVSP PCL KT-43 – Baseline Storage – 5750 Baseline Road

File # PL19-0350

Page 13 of 44

project would not produce substantial emissions of criteria air pollutants, CO, or TACs, adjacent residents would not be exposed to significant levels of pollutant concentrations during construction or operation. Impacts are less than significant.

The project is subject to the SVSP Mitigation Monitoring and Reporting Program (MMRP). The applicable Air Quality Mitigation Measures (MM 4.4-1) can be found in the Table of Applicable Mitigation Measures, which is included as Attachment 2 to this document. As this is a requirement of the specific plan, no mitigation is required.

e) Diesel fumes from construction equipment and delivery trucks are often found to be objectionable; however, construction is temporary and diesel emissions are minimal and regulated. Typical urban projects such as residences and retail businesses generally do not result in substantial objectionable odors when operated in compliance with City Ordinances (e.g. proper trash disposal and storage). The Project is a typical urban development that lacks any characteristics that would cause the generation of substantial unpleasant odors. Thus, construction and operation of the proposed project would not result in the creation of objectionable odors affecting a substantial number of people. A review of the project surroundings indicates that there are no substantial odor-generating uses near the project site; the project location meets the recommended screening distances from odor-generators provided by the PCAPCD. Impacts related to odors are less than significant.

IV. Biological Resources

The project site is relatively flat with vegetation consisting entirely of non-annual grassland. No protected trees are on or immediately surrounding the subject property. In addition, there are no wetlands or other regulated waters on the site.

Would the project:

Environmental Issue	Potentially Significant Impact	Less Than Significant With Mitigation	Less Than Significant Impact	No Impact
a) Have a substantial adverse effect, either directly or through habitat modifications, on any species identified as a candidate, sensitive, or special status species in local or regional plans, policies or regulations, or by the California Department of Fish and Game or U.S. Fish and Wildlife Service?			X	
b) Have a substantial adverse effect on any riparian habitat or other sensitive natural community identified in local or regional plans, policies or regulations or by the California Department of Fish and Wildlife or U.S. Fish and Wildlife Service?			X	

PC Exhibit A

INITIAL STUDY

October 15, 2020

SVSP PCL KT-43 – Baseline Storage – 5750 Baseline Road

File # PL19-0350

Page 14 of 44

Environmental Issue	Potentially Significant Impact	Less Than Significant With Mitigation	Less Than Significant Impact	No Impact
c) Have a substantial adverse effect on state or federally protected wetlands (including, but not limited to, marsh, vernal pool, coastal, etc.) through direct removal, filling, hydrological interruption, or other means?			X	
d) Interfere substantially with the movement of any native resident or migratory fish or wildlife species or with established native resident or migratory wildlife corridors, or impede the use of native wildlife nursery sites?			X	
e) Conflict with any local policies or ordinances protecting biological resources, such as a tree preservation policy or ordinance?			X	
f) Conflict with the provisions of an adopted Habitat Conservation Plan, Natural Community Conservation Plan, or other approved local, regional, or state habitat conservation plan?			X	

Thresholds of Significance and Regulatory Setting:

There is no ironclad definition of significance as it relates to biological resources. Thus, the significance of impacts to biological resources is defined by the use of expert judgment supported by facts, and relies on the policies, codes, and regulations adopted by the City and by regulatory agencies which relate to biological resources (as cited and described in the Discussion of Checklist Answers section). Thresholds for assessing the significance of environmental impacts are based on the CEQA Guidelines checklist items a–f, above. Consistent with CEQA Guidelines Section 15065, a project may have a significant effect on the environment if:

The project has the potential to substantially degrade the quality of the environment; substantially reduce the habitat of a fish or wildlife species; cause a fish or wildlife population to drop below self-sustaining levels; threaten to eliminate a plant or animal community; [or] substantially reduce the number or restrict the range of an endangered, rare or threatened species . . .

Various agencies regulate impacts to the habitats and animals addressed by the CEQA Guidelines checklist. These include the United States Fish and Wildlife Service, National Oceanic and Atmospheric Administration–

Fisheries, United States Army Corps of Engineers, Central Valley Regional Water Quality Control Board, and California Department of Fish and Wildlife. The primary regulations affecting biological resources are described in the sections below.

Checklist item a addresses impacts to special status species. A “special status” species is one which has been identified as having relative scarcity and/or declining populations. Special status species include those formally listed as threatened or endangered, those proposed for formal listing, candidates for federal listing, and those classified as species of special concern. Also included are those species considered to be “fully protected” by the California Department of Fish and Wildlife (California Fish and Wildlife), those granted “special animal” status for tracking and monitoring purposes, and those plant species considered to be rare, threatened, or endangered in California by the California Native Plant Society (CNPS). The primary regulatory protections for special status species are within the Federal Endangered Species Act, California Endangered Species Act, California Fish and Game Code, and the Federal Migratory Bird Treaty Act.

Checklist item b addresses all “sensitive natural communities” and riparian (creekside) habitat that may be affected by local, state, or federal regulations/policies while checklist item c focuses specifically on one type of such a community: protected wetlands. Focusing first on wetlands, the 1987 Army Corps Wetlands Delineation Manual is used to determine whether an area meets the technical criteria for a wetland. A delineation verification by the Army Corps verifies the size and condition of the wetlands and other waters in question, and determines the extent of government jurisdiction as it relates to Section 404 of the Federal Clean Water Act and Section 401 of the State Clean Water Act.

The Clean Water Act protects all “navigable waters”, which are defined as traditional navigable waters that are or were used for commerce, or may be used for interstate commerce; tributaries of covered waters; and wetlands adjacent to covered waters, including tributaries. Non-navigable waters are called isolated wetlands, and are not subject to either the Federal or State Clean Water Act. Thus, isolated wetlands are not subject to federal wetland protection regulations. However, in addition to the Clean Water Act, the State also has jurisdiction over impacts to surface waters through the Porter-Cologne Water Quality Control Act (Porter-Cologne), which does not require that waters be “navigable”. For this reason, isolated wetlands are regulated by the State of California pursuant to Porter-Cologne. The City of Roseville General Plan also provides protection for wetlands, including isolated wetlands, pursuant to the General Plan Open Space and Conservation Element. Federal, State and City regulations/policies all seek to achieve no net loss of wetland acreage, values, or function.

Aside from wetlands, checklist item b also addresses other “sensitive natural communities” and riparian habitat, which includes any habitats protected by local or regional plans, policies, or regulations, or by the California Department of Fish and Wildlife or U.S. Fish and Wildlife Service. The City of Roseville General Plan Open Space and Conservation Element includes policies for the protection of riparian areas and floodplain areas; these are Vegetation and Wildlife section Policies 2 and 3. Policy 4 also directs preservation of additional area around stream corridors and floodplain if there is sensitive woodland, grassland, or other habitat which could be made part of a contiguous open space area. Other than wetlands, which were already discussed, US Fish and Wildlife and California Department of Fish and Wildlife habitat protections generally result from species protections, and are thus addressed via checklist item a.

For checklist item d, there are no regulations specific to the protection of migratory corridors. This item is addressed by an analysis of the habitats present in the vicinity and analyzing the probable effects on access to those habitats which will result from a project.

The City of Roseville Tree Preservation ordinance (RMC Ch.19.66) requires protection of native oak trees, and compensation for oak tree removal. The Findings of the Implementing Procedures indicate that compliance with the City of Roseville Tree Preservation ordinance (RMC Ch.19.66) will prevent significant impacts related to loss of native oak trees, referenced by item e, above.

PC Exhibit A

INITIAL STUDY

October 15, 2020

SVSP PCL KT-43 – Baseline Storage – 5750 Baseline Road

File # PL19-0350

Page 16 of 44

Regarding checklist item f, there are no adopted Habitat Conservation Plans within the City of Roseville.

Discussion of Checklist Answers:

a&b) A Biological Resource Assessment was prepared as part of the SVSP. The assessment included list of species with the potential to occur within the SVSP plan area based on the species known to occur within the Pleasant Grove and Roseville 7.5 minute U.S. Geological Survey quadrangles. A review of this list determined that the project site contains potential habitat for nesting burrowing owls. Pursuant to the SVSP Mitigation Measure 4.8-3, preconstruction surveys for active burrows will be required prior to grading plan approval. As this is a requirement of the specific plan, no mitigation is required. This measure will ensure that no nesting burrowing owls are impacted during grading and ground disturbing activities. Impacts are less than significant.

d) The City includes an interconnected network of open space corridors and preserves located throughout the City, to ensure that the movement of wildlife is not substantially impeded as the City develops. The development of the project site will not negatively impact these existing and planned open space corridors, nor is the project site located in an area that has been designated by the City, United States Fish and Wildlife, or California Department of Fish and Wildlife as vital or important for the movement of wildlife or the use of native wildlife nursery sites.

e) There are no protected trees or unprotected trees on the subject property.

f) There are no Habitat Conservation Plans; Natural Community Conservation Plans; or other approved local, regional, or state habitat conservation plans that apply to the project site.

V. Cultural Resources

As described within the Open Space and Conservation Element of the City of Roseville General Plan, the Roseville region was within the territory of the Nisenan (also Southern Maidu or Valley Maidu). Two large permanent Nisenan habitation sites have been identified and protected within the City's open space (in Maidu Park). Numerous smaller cultural resources, such as midden deposits and bedrock mortars, have also been recorded in the City. The gold rush which began in 1848 marked another settlement period, and evidence of Roseville's ranching and mining past are still found today. Historic features include rock walls, ditches, low terraces, and other remnants of settlement and activity. A majority of documented sites within the City are located in areas designated for open space uses.

Would the project:

Environmental Issue	Potentially Significant Impact	Less Than Significant With Mitigation	Less Than Significant Impact	No Impact
a) Cause a substantial adverse change in the significance of an historic resource pursuant to in Section 15064.5?			X	
b) Cause a substantial adverse change in the significance of an archaeological resource pursuant to Section 15064.5?			X	

PC Exhibit A

INITIAL STUDY

October 15, 2020

SVSP PCL KT-43 – Baseline Storage – 5750 Baseline Road

File # PL19-0350

Page 17 of 44

Environmental Issue	Potentially Significant Impact	Less Than Significant With Mitigation	Less Than Significant Impact	No Impact
c) Disturb any human remains, including those interred outside of dedicated cemeteries?			X	

Thresholds of Significance and Regulatory Setting:

The significance of impacts to cultural resources is based directly on the CEQA Guidelines checklist items a–e listed above. The Archaeological, Historic, and Cultural Resources section of the City of Roseville General Plan also directs the proper evaluation of and, when feasible, protection of significant resources (Policies 1 and 2). There are also various federal and State regulations regarding the treatment and protection of cultural resources, including the National Historic Preservation Act and the Antiquities Act (which regulate items of significance in history), Section 7050.5 of the California Health and Safety Code, Section 5097.9 of the California Public Resources Code (which regulates the treatment of human remains) and Section 21073 et seq. of the California Public Resources Code (regarding Tribal Cultural Resources). The CEQA Guidelines also contains specific sections, other than the checklist items, related to the treatment of effects on historic resources.

Pursuant to the CEQA Guidelines, if it can be demonstrated that a project will cause damage to a unique archaeological resource, the lead agency may require reasonable efforts to be made to permit any or all of these resources to be preserved in place or left in an undisturbed state. To the extent that they cannot be left undisturbed, mitigation measures are required (Section 21083.2 (a), (b), and (c)). A *historical resource* is a resource listed, or determined to be eligible for listing, in the California Register of Historical Resources (CRHR) (Section 21084.1); a resource included in a local register of historical resources (Section 15064.5(a)(2)); or any object, building, structure, site, area, place, record, or manuscript which a lead agency determines to be historically significant (Section 15064.5 (a)(3)). Public Resources Code Section 5024.1 requires evaluation of historical resources to determine their eligibility for listing on the CRHR.

Discussion of Checklist Answers:

a–b and d) No cultural resources are known to exist on the project site per the SVSP EIR; however, standard mitigation measures apply which are designed to reduce impacts to cultural resources, should any be found on-site. The measure requires an immediate cessation of work, and contact with the appropriate agencies to address the resource before work can resume. The project will not result in any new impacts beyond those already discussed and disclosed in the SVSP EIR; project-specific impacts are less than significant. The project is subject to the SVSP MMRP and the applicable Cultural Resources Mitigation Measures (MM 4.9-1). These measures are included in the Table of Applicable Mitigation Measures, which is included as Attachment 2 to this document. As this is a requirement of the specific plan, no mitigation is required.

c) No paleontological resources are known to exist on the project site per the SVSP EIR; however, standard mitigation measures apply which are designed to reduce impacts to such resources, should any be found on-site. The measure requires an immediate cessation of work, and contact with the appropriate agencies to address the resource before work can resume. The project will not result in any new impacts beyond those already discussed and disclosed in the SVSP EIR; project-specific impacts are less than significant. The project is subject to the SVSP MMRP and the applicable Cultural Resources Mitigation Measures (MM 4.9-3). These measures are included in the Table of Applicable Mitigation Measures, which is included as Attachment 2 to this document. As this is a requirement of the specific plan, no mitigation is required.

VI. Energy

Roseville Electric provides electrical power in the City, and Pacific Gas and Electric (PG&E) provides natural gas. The City purchases wholesale electrical power from both the Western Area Power Administration (WAPA), which is generated by the federal government’s Central Valley Project, which produces 100-percent hydroelectric energy sources from a system of dams, reservoirs, and power plants within central and northern California. In addition, up to 50-percent of the City’s power is generated at the City-owned Roseville Energy Park (REP). The REP is a 160 megawatt natural-gas-fired power plant that uses a combined cycle gas turbine technology. The City also owns the 48 megawatt combustion-turbine Roseville Power Plant 2 (REP 2), which is used for peaking energy. The City’s electric power mix varies from year to year, but according to the most recent Citywide energy analysis (the Amoruso Ranch EIR), the mix in 2013/2014 was 25-percent eligible renewable (geothermal, small hydroelectric, and wind), 14-percent hydroelectric, 48-percent natural gas, and 13-percent from other sources (power purchased by contract).

Would the project:

Environmental Issue	Potentially Significant Impact	Less Than Significant With Mitigation	Less Than Significant Impact	No Impact
a) Result in potentially significant environmental impact due to wasteful, inefficient, or unnecessary consumption of energy resources, during project construction or operation?			X	
b) Conflict with or obstruct a state or local plan for renewable energy or energy inefficiency?			X	

Thresholds of Significance and Regulatory Setting:

Established in 2002, California’s Renewable Portfolio Standard (RPS) currently requires that 33 percent of electricity retail sales be served by renewable energy resources by 2020, and 50 percent by 2030. The City published a Renewables Portfolio Standard Procurement Plan in June 2018, and continues to comply with the RPS reporting and requirements and standards. There are no numeric significance thresholds to define “wasteful, inefficient, or unnecessary” energy consumption, and therefore significance is based on CEQA Guidelines checklist items a and b, above, and by the use of expert judgment supported by facts, relying on the policies, codes, and regulations adopted by the City and by regulatory agencies which relate to energy. The analysis considers compliance with regulations and standards, project design as it relates to energy use (including transportation energy), whether the project will result in a substantial unplanned demand on the City’s energy resources, and whether the project will impede the ability of the City to meet the RPS standards.

Discussion of Checklist Answers:

a & b) The project would consume energy both during project construction and during project operation. During construction, fossil fuels, electricity, and natural gas would be used by construction vehicles and equipment. However, the energy consumed during construction would be temporary, and would not represent a significant demand on available resources. There are no unusual project characteristics that would necessitate the use of construction equipment or methods that would be less energy-efficient or which would be wasteful.

PC Exhibit A

INITIAL STUDY

October 15, 2020

SVSP PCL KT-43 – Baseline Storage – 5750 Baseline Road

File # PL19-0350

Page 19 of 44

The completed project would consume energy related to building operation, exterior lighting, landscape irrigation and maintenance, and vehicle trips to and from the use. In accordance with California Energy Code Title 24, the project would be required to meet the Building Energy Efficiency Standards. This includes standards for water and space heating and cooling equipment; insulation for doors, pipes, walls, and ceilings; and appliances, to name a few. The project would also be eligible for rebates and other financial incentives from both the electric and gas providers for the purchase of energy-efficient appliances and systems, which would further reduce the operational energy demand of the project. The project was distributed to both PG&E and Roseville Electric for comments, and was found to conform to the standards of both providers; energy supplies are available to serve the project.

The project is consistent with the existing land use designation, and has therefore been assumed for development with commercial uses in citywide environmental analyses, such as in the Amoruso Ranch Specific Plan, which updated the City's General Plan. The project is therefore consistent with the current citywide assessment of energy demand, and will not result in substantial unplanned demands. In addition, based on the foregoing analysis, the project will not result in inefficient, wasteful, or unnecessary consumption of energy; therefore, impacts are less than significant.

VII. Geology and Soils

As described in the Safety Element of the City of Roseville General Plan, there are three inactive faults (Volcano Hill, Linda Creek, and an unnamed fault) in the vicinity, but there are no known active seismic faults within Placer County. The last seismic event recorded in the South Placer area occurred in 1908, and is estimated to have been at least a 4.0 on the Richter Scale. Due to the geographic location and soil characteristics within the City, the General Plan indicates that soil liquefaction, landslides, and subsidence are not a significant risk in the area.

Would the project:

Environmental Issue	Potentially Significant Impact	Less Than Significant With Mitigation	Less Than Significant Impact	No Impact
a) Directly or indirectly cause potential substantial adverse effects, including the risk of loss, injury, or death involving:				
i) Ruptures of a known earthquake fault, as delineated on the most recent Alquist-Priolo Earthquake Fault Zoning Map issued by the State Geologist for the area or based on other substantial evidence of a known fault? (Refer to Division of Mines and Geology Special Publication 42.)			X	
ii) Strong seismic ground shaking?			X	
iii) Seismic-related ground failure, including liquefaction?			X	
iv) Landslides?			X	

PC Exhibit A

INITIAL STUDY

October 15, 2020

SVSP PCL KT-43 – Baseline Storage – 5750 Baseline Road

File # PL19-0350

Page 20 of 44

Environmental Issue	Potentially Significant Impact	Less Than Significant With Mitigation	Less Than Significant Impact	No Impact
b) Result in substantial soil erosion or the loss of topsoil?			X	
c) Be located in a geological unit or soil that is unstable, or that would become unstable as a result of the project, and potentially result in on or off-site landslide, lateral spreading, subsidence, liquefaction or collapse?			X	
d) Be located on expansive soil, as defined in Table 18-1-B of the Uniform Building Code (1994), creating substantial direct or indirect risks to life or property?			X	
e) Have soils incapable of adequately supporting the use of septic tanks or alternative wastewater disposal systems where sewers are not available for the disposal of wastewater?			X	
f) Directly or indirectly destroy a unique paleontological resource or site or unique geological feature?			X	

Thresholds of Significance and Regulatory Setting:

The significance of impacts related to geology and soils is based directly on the CEQA Guidelines checklist items a–f listed above. Regulations applicable to this topic include the Alquist-Priolo Act, which addresses earthquake safety in building permits, and the Seismic Hazards Mapping Act, which requires the state to gather and publish data on the location and risk of seismic faults. The Archaeological, Historic, and Cultural Resources section of the City of Roseville General Plan also directs the proper evaluation of and, when feasible, protection of significant archeological resources, which for this evaluation will include paleontological resources (Policies 1 and 2). Section 50987.5 of the California Public Code Section is only applicable to public land; this section prohibits the excavation, removal, destruction, or defacement/injury to any vertebrate paleontological site, including fossilized footprints or other paleontological feature.

The Findings of the Implementing Procedures indicate that compliance with the Flood Damage Prevention Ordinance (RMC Ch.9.80) and Design/Construction Standards (Resolution 07-107) will prevent significant impacts related to checklist item b. The Ordinance and standards include permit requirements for construction and development in erosion-prone areas and ensure that grading activities will not result in significant soil erosion

or loss of topsoil. The use of septic tanks or alternative waste systems is not permitted in the City of Roseville, and therefore no analysis of criterion e is necessary.

Discussion of Checklist Answers:

a) The project will not expose people or structures to potential substantial adverse effects involving seismic shaking, ground failure or landslides.

i-iii) According to United States Geological Service mapping and literature, active faults are largely considered to be those which have had movement within the last 10,000 years (within the Holocene or Historic time periods)¹ and there are no major active faults in Placer County. The California Geological Survey has prepared a map of the state which shows the earthquake shaking potential of areas throughout California based primarily on an area's distance from known active faults. The map shows that the City lies in a relatively low-intensity ground-shaking zone. Commercial, institutional, and residential buildings as well as all related infrastructure are required, in conformance with Chapter 16, *Structural Design Requirements*, Division IV, *Earthquake Design* of the California Building Code, to lessen the exposure to potentially damaging vibrations through seismic-resistant design. In compliance with the Code, all structures in the Project area would be well-built to withstand ground shaking from possible earthquakes in the region; impacts are less than significant.

iv) Landslides typically occur where soils on steep slopes become saturated or where natural or manmade conditions have taken away supporting structures and vegetation. The existing and proposed slopes of the project site are not steep enough to present a hazard during development or upon completion of the project. In addition, measures would be incorporated during construction to shore minor slopes and prevent potential earth movement. Therefore, impacts associated with landslides are less than significant.

b) Grading activities will result in the disruption, displacement, compaction and over-covering of soils associated with site preparation (grading and trenching for utilities). Grading activities for the project will be limited to the project site. Grading activities require a grading permit from the Engineering Division. The grading permit is reviewed for compliance with the City's Improvement Standards, including the provision of proper drainage, appropriate dust control, and erosion control measures. Grading and erosion control measures will be incorporated into the required grading plans and improvement plans. Therefore, the impacts associated with disruption, displacement, and compaction of soils associated with the project are less than significant.

c, d) A review of the Natural Resources Conservation Service Soil Survey for Placer County, accessed via the Web Soil Survey (<http://websoilsurvey.nrcs.usda.gov/app/>), indicates that the soils on the site are Fiddyment-Kaseberg loams with 2 to 9 percent slope and San Joaquin-Cometa sandy loams with 1 to 5 percent slopes, which are not listed as geologically unstable or sensitive.

f) No paleontological resources are known to exist on the project site per the SVSP EIR; however, standard mitigation measures apply which are designed to reduce impacts to such resources, should any be found on-site. The measure requires an immediate cessation of work, and contact with the appropriate agencies to address the resource before work can resume. The project will not result in any new impacts beyond those already discussed and disclosed in the SVSP EIR; project-specific impacts are less than significant.

VIII. Greenhouse Gases

Greenhouse gases trap heat in the earth's atmosphere. The principal greenhouse gases (GHGs) that enter the atmosphere because of human activities are carbon dioxide (CO₂), methane (CH₄), nitrous oxide (N₂O), and fluorinated gases. As explained by the United States Environmental Protection Agency², global average

¹ United States Geological Survey, <http://earthquake.usgs.gov/learn/glossary/?term=active%20fault>, Accessed January 2016

² <http://www3.epa.gov/climatechange/science/overview.html>, Accessed January 2016

PC Exhibit A

INITIAL STUDY

October 15, 2020

SVSP PCL KT-43 – Baseline Storage – 5750 Baseline Road

File # PL19-0350

Page 22 of 44

temperature has increased by more than 1.5 degrees Fahrenheit since the late 1800s, and most of the warming of the past half century has been caused by human emissions. The City has taken proactive steps to reduce greenhouse gas emissions, which include the introduction of General Plan policies to reduce emissions, changes to City operations, and climate action initiatives.

Would the project:

Environmental Issue	Potentially Significant Impact	Less Than Significant With Mitigation	Less Than Significant Impact	No Impact
a) Generate greenhouse gas emissions, either directly or indirectly, that may have a significant impact on the environment?			X	
b) Conflict with an applicable plan, policy, or regulation adopted for the purpose of reducing the emissions of greenhouse gases?			X	

Thresholds of Significance and Regulatory Setting:

In Assembly Bill 32 (the California Global Warming Solutions Act), signed by Governor Schwarzenegger of California in September 2006, the legislature found that climate change resulting from global warming was a threat to California, and directed that “the State Air Resources Board design emissions reduction measures to meet the statewide emissions limits for greenhouse gases . . .”. The target established in AB 32 was to reduce emissions to 1990 levels by the year 2020. CARB subsequently prepared the *Climate Change Scoping Plan* (Scoping Plan) for California, which was approved in 2008. The Scoping Plan provides the outline for actions to reduce California’s GHG emissions. CARB’s updated August 2011 Scoping Plan calculated a reduction needed of 21.7% from future “Business As Usual” (BAU) conditions in the year 2020. The current Scoping Plan (adopted May 2014) indicates that statewide emissions of GHG in 1990 amounted to 431 million metric tons, and that the 2020 “Business As Usual” (BAU) scenario is estimated as 509³ million metric tons, which would require a reduction of 15.3% from 2020 BAU. In addition to this, Senate Bill 32 was signed by the Governor on September 8, 2016, to establish a reduction target of 40 percent below 1990 levels by 2030. The Air Resources Board is currently updating the Scoping Plan to reflect this target.

The Placer County Air Pollution Control District (PCAPCD) recommends that thresholds of significance for GHG be related to AB 32 reduction goals, and has adopted thresholds of significance which take into account the 2030 reduction target. The thresholds include a de minimis and a bright-line maximum threshold. Any project emitting less than 1,100 metric tons of carbon dioxide equivalents per year (MT CO₂e/yr) during construction or operation results in less than significant impacts. The PCAPCD considers any project with emissions greater than the bright-line cap of 10,000 MT CO₂e/yr to have significant impacts. For projects exceeding the de minimum threshold but below the bright-line threshold, comparison to the appropriate efficiency threshold is recommended. The significance thresholds are shown in Table 1 below.

³ Includes Paveley and Renewables Portfolio Standard reduction

Table 1: GHG Significance Thresholds

Bright-line Threshold 10,000 MT CO ₂ e/yr			
Residential Efficiency (MT CO ₂ e/capita ¹)		Non-Residential Efficiency (MT CO ₂ e/ksf ²)	
Urban	Rural	Urban	Rural
4.5	5.5	26.5	27.3
De Minimis Threshold 1,100 MT CO ₂ e/yr			
1. Per Capita = per person			
2. Per ksf = per 1,000 square feet of building			

Discussion of Checklist Answers:

a–b) Greenhouse gases are primarily emitted as a result of vehicle operation associated with trips to and from a project, and energy consumption from operations of the buildings. Greenhouse gases from vehicles are assessed based on the vehicle miles traveled (VMT) resulting from a project, on a Citywide basis. Residential project, destination centers (such as a regional mall), and major employers tend to increase VMT in a study area, either by adding new residents traveling in an area, or by encouraging longer trip lengths and drawing in trips from a broader regional area. However, non-residential projects and neighborhood-serving uses (e.g. neighborhood parks) tend to lower VMT in a study area because they do not generate new trips within the study area, they divert existing trips. These trips are diverted because the new use is closer to home, on their way to another destination (e.g. work), or is otherwise more convenient.

The proposed project includes a self-storage facility and associated RV/boat storage, office, and manager’s residence, which are non-residential uses with low traffic generation. As discussed in the Transportation section of this Initial Study, the project would not be anticipated to increase VMT, since it is providing services in closer proximity to a developing residential area of the City

CalEEMod 2016.3.2 was used to calculate the operational emissions of the project (see Attachment 1), which includes energy to run the office building, area emissions such as landscape equipment to maintain the site, and water and wastewater energy demands. According to the CalEEMod results, the project would result in annual emissions of 829 MT CO₂e.

Construction-related GHG emissions occur at one point in time and are therefore not typically expected to significantly contribute to climate change. Climate change is a cumulative effect that occurs over time, as emissions increase on a year-to-year basis due to increase in developed area and other factors; construction emissions are a one-time emission source, which end once the project is built. However, the proposed project’s construction-related GHG has been estimated, and have been amortized over the life of the project (25 years, based on PCAPCD guidance). The CalEEMod results indicate total construction emissions of 344 MT CO₂e.

The PCAPCD screening threshold for GHG indicates that projects resulting in less than 1,100 CO₂e/yr will result in less than significant impacts. The proposed project will result in GHG emissions which are below thresholds established by the PCAPCD. Thus, project-generated GHG emissions would not conflict with, and are consistent with, the State goals listed in AB32 and policies and regulation adopted by the California Air Resources Board pursuant to AB32. This impact is considered less than significant.

IX. Hazards and Hazardous Materials

There are no known hazardous materials located on the subject property, and no indication that there is the potential for hazardous materials. EnviroStor, the California Department of Toxic Substances Control’s data

PC Exhibit A

INITIAL STUDY

October 15, 2020

SVSP PCL KT-43 – Baseline Storage – 5750 Baseline Road

File # PL19-0350

Page 24 of 44

management system, indicated that no hazardous waste facilities or sites with known contamination are located within 1,000 feet of the subject parcel. Similarly, the GeoTracker application, which is the California State Water Resources Control Board's data management system that tracks sites which impact or have the potential to impact water quality (particularly groundwater) in California, did not indicate that there were any sites requiring cleanup within 1,000 feet of the project site.

Would the project:

Environmental Issue	Potentially Significant Impact	Less Than Significant With Mitigation	Less Than Significant Impact	No Impact
a) Create a significant hazard to the public or the environment through the routine transport, use, or disposal of hazardous materials?			X	
b) Create a significant hazard to the public or the environment through reasonably foreseeable upset and accident conditions involving the release of hazardous materials into the environment?			X	
c) Emit hazardous emissions or handle hazardous or acutely hazardous materials, substances, or waste within one-quarter mile of an existing or proposed school?				X
d) Be located on a site which is included on a list of hazardous materials sites compiled pursuant to Government Code Section 65962.5 and, as a result, would it create a significant hazard to the public or the environment?				X
e) For a project located within an airport land use plan or, where such a plan has not been adopted, within two miles of a public airport or public use airport, would the project result in a safety hazard or excessive noise for people residing or working in the project area?				X

PC Exhibit A

INITIAL STUDY

October 15, 2020

SVSP PCL KT-43 – Baseline Storage – 5750 Baseline Road

File # PL19-0350

Page 25 of 44

Environmental Issue	Potentially Significant Impact	Less Than Significant With Mitigation	Less Than Significant Impact	No Impact
f) Impair implementation of or physically interfere with an adopted emergency response plan or emergency evacuation plan?				X
g) Expose people or structures either directly or indirectly to a significant risk of loss, injury or death involving wildland fires?				X

Thresholds of Significance and Regulatory Setting:

The significance of impacts related to hazardous materials is based directly on the CEQA Guidelines checklist items a–g listed above. A material is defined as hazardous if it appears on a list of hazardous materials prepared by a federal, state or local regulatory agency, or if it has characteristics defined as hazardous by such an agency. The determination of significance based on the above criteria depends on the probable frequency and severity of consequences to people who might be exposed to the health hazard, and the degree to which Project design or existing regulations would reduce the frequency of or severity of exposure. As an example, products commonly used for household cleaning are classified as hazardous when transported in large quantities, but one would not conclude that the presence of small quantities of household cleaners at a home would pose a risk to a school located within ¼-mile.

Many federal and State agencies regulate hazards and hazardous substances, including the United States Environmental Protection Agency (US EPA), California Department of Toxic Substances Control (DTSC), Central Valley Regional Water Quality Control Board (Regional Water Board), and the California Occupational Safety and Health Administration (CalOSHA). The state has been granted primacy (primary responsibility for oversight) by the US EPA to administer and enforce hazardous waste management programs. State regulations also have detailed planning and management requirements to ensure that hazardous materials are handled, stored, and disposed of properly to reduce human health risks. California regulations pertaining to hazardous waste management are published in the California Code of Regulations (see 8 CCR, 22 CCR, and 23 CCR).

The project is not within an airport land use plan or within two miles of a public or private use airport. Therefore, no further discussion is provided for item e.

Discussion of Checklist Answers:

a, b) Standard construction activities would require the use of hazardous materials such as fuels, oils, lubricants, glues, paints and paint thinners, soaps, bleach, and solvents. These are common household and commercial materials routinely used by both businesses and average members of the public. The materials only pose a hazard if they are improperly used, stored, or transported either through upset conditions (e.g. a vehicle accident) or mishandling. In addition to construction use, the operational project would result in the use of common hazardous materials as well, including bleach, solvents, and herbicides. Regulations pertaining to the transport of materials are codified in 49 Code of Federal Regulations 171–180, and transport regulations are enforced and monitored by the California Department of Transportation and by the California Highway Patrol. Specifications for storage on a construction site are contained in various regulations and codes, including the California Code of Regulations, the Uniform Fire Code, and the California Health and Safety Code. These same codes require that all hazardous materials be used and stored in the manner specified on the material packaging.

PC Exhibit A

INITIAL STUDY

October 15, 2020

SVSP PCL KT-43 – Baseline Storage – 5750 Baseline Road

File # PL19-0350

Page 26 of 44

Existing regulations and programs are sufficient to ensure that potential impacts as a result of the use or storage of hazardous materials are reduced to less than significant levels.

c) See response to Items (a) and (b) above. While development of the site will result in the use, handling, and transport of materials deemed to be hazardous, the materials in question are commonly used in both residential and commercial applications, and include materials such as bleach and herbicides. The project will not result in the use of any acutely hazardous materials, substances, or waste.

d) The project is not located on a site that is included on a list of hazardous materials sites compiled pursuant to Government Code Section 65962.5⁴; therefore, no impact will occur.

e) This project is located within an area currently receiving City emergency services and development of the site has been anticipated and incorporated into emergency response plans. Therefore, the project will cause a less than significant impact to the City's Emergency Response or Management Plans. Furthermore, the project will be required to comply with all local, State and federal requirements for the handling of hazardous materials, which will ensure less-than-significant impacts. These will require the following programs:

- A Risk Management and Prevention Program (RMPP) is required of uses that handle toxic and/or hazardous materials in quantities regulated by the California Health and Safety Code and/or the City.
- Businesses that handle toxic or hazardous materials are required to complete a Hazardous Materials Management Program (HMMP) pursuant to local, State, or federal requirements.

g) The California Department of Forestry and Fire Protection (CAL FIRE) is the state agency responsible for wildland fire protection and management. As part of that task, CAL FIRE maintains maps designating Wildland Fire Hazard Severity zones. The City is not located within a Very High Fire Hazard Severity Zone, and is not in a CAL FIRE responsibility area; fire suppression is entirely within local responsibility. The project site is in an urban area, and therefore would not expose people to any risk from wildland fire. There would be no impact with regard to this criterion.

X. Hydrology and Water Quality

As described in the Open Space and Conservation Element of the City of Roseville General Plan, the City is located within the Pleasant Grove Creek Basin and the Dry Creek Basin. Pleasant Grove Creek and its tributaries drain most of the western and central areas of the City and Dry Creek and its tributaries drain the remainder of the City. Most major stream areas in the City are located within designated open space.

Would the project:

Environmental Issue	Potentially Significant Impact	Less Than Significant With Mitigation	Less Than Significant Impact	No Impact
a) Violate any water quality standards or waste discharge requirements or otherwise substantially degrade surface or ground water quality?			X	

⁴ <http://www.calepa.ca.gov/SiteCleanup/CorteseList/SectionA.htm>

PC Exhibit A

INITIAL STUDY

October 15, 2020

SVSP PCL KT-43 – Baseline Storage – 5750 Baseline Road

File # PL19-0350

Page 27 of 44

Environmental Issue	Potentially Significant Impact	Less Than Significant With Mitigation	Less Than Significant Impact	No Impact
b) Substantially decrease groundwater supplies or interfere substantially with groundwater recharge such that the project may impede sustainable groundwater management of the basin?			X	
c) Substantially alter the existing drainage pattern of the site or area, including through the alteration of the course of a stream or river or through the addition of impervious surfaces, in a manner which would:			X	
i) result in substantial erosion or siltation on or off-site;			X	
ii) substantially increase the rate or amount of surface runoff in a manner which would result in flooding on- or off-site;			X	
iii) create or contribute runoff water which would exceed the capacity of existing or planned stormwater systems or provide substantial additional sources of polluted runoff; or			X	
iv) impede or redirect flood flows?			X	
d) Conflict with or obstruct implementation of a water quality control plan or sustainable groundwater management plan?			X	
e) In flood hazard, tsunami, or seiches zones, risk release of pollutants due to project inundation?				X

Thresholds of Significance and Regulatory Setting:

The significance of impacts related to hydrology and water quality is based directly on the CEQA Guidelines checklist items a–e listed above. For checklist item a, c (i), d, and e, the Findings of the Implementing Procedures indicate that compliance with the City of Roseville Design/Construction Standards (Resolution 07-107), Urban Stormwater Quality Management and Discharge Control Ordinance (RMC Ch. 14.20), and Stormwater Quality Design Manual (Resolution 16-152) will prevent significant impacts related to water quality or erosion. The standards require preparation of an erosion and sediment control plan for construction activities and includes designs to control pollutants within post-construction urban water runoff. Likewise, it is indicated that the Drainage Fees for the Dry Creek and Pleasant Grove Watersheds (RMC Ch.4.48) and City of Roseville Design/Construction Standards (Resolution 07-107) will prevent significant impacts related to checklist items c (ii) and c (iii). The ordinance and standards require the collection of drainage fees to fund improvements that mitigate potential flooding impacts, and require the design of a water drainage system that will adequately convey anticipated stormwater flows without increasing the rate or amount of surface runoff. These same ordinances and standards prevent impacts related to groundwater (items a and d), because developers are required to treat and detain all stormwater onsite using stormwater swales and other methods which slow flows and preserve infiltration. Finally, it is indicated that compliance with the Flood Damage Prevention Ordinance (RMC Ch. 9.80) will prevent significant impacts related to items c (iv) and e. The Ordinance includes standard requirements for all new construction, including regulation of development with the potential to impede or redirect flood flows, and prohibits development within flood hazard areas. Impacts from tsunamis and seiches were screened out of the analysis (item e) because the project is not located near a water body or other feature that would pose a risk of such an event.

Discussion of Checklist Answers:

a, c (i), d, e) The project will involve the disturbance of on-site soils and the construction of impervious surfaces, such as asphalt paving and buildings. Disturbing the soil can allow sediment to be mobilized by rain or wind, and cause displacement into waterways. To address this and other issues, the developer is required to receive approval of a grading permit and/or improvement plants prior to the start of construction. The permit or plans are required to incorporate mitigation measures for dust and erosion control. In addition, the City has a National Pollutant Discharge Elimination System (NPDES) Municipal Stormwater Permit issued by the Central Valley Regional Water Quality Control Board which requires the City to reduce pollutants in stormwater to the maximum extent practicable. The City does this, in part, by means of the City's 2016 Design/Construction Standards, which require preparation and implementation of a Stormwater Pollution Prevention Plan. All permanent stormwater quality control measures must be designed to comply with the City's Manual for Stormwater Quality Control Standards for New Development, the City's 2016 Design/Construction Standards, Urban Stormwater Quality Management and Discharge Control Ordinance, and Stormwater Quality Design Manual. For these reasons, impacts related to water quality are less than significant.

b, d) The project does not involve the installation of groundwater wells. The City maintains wells to supplement surface water supplies during multiple dry years, but the effect of groundwater extraction on the aquifer was addressed in the Water Supply Assessment of the Amoruso Ranch Specific Plan EIR, which included a Citywide water analysis. The proposed project is consistent with the General Plan land use designation, and is thus consistent with the citywide Water Supply Assessment. Project impacts related to groundwater extraction are less than significant. Furthermore, all permanent stormwater quality control measures must be designed to comply with the Stormwater Quality Design Manual, which requires the use of bioswales and other onsite detention and infiltration methods. These standards ensure that stormwater will continue to infiltrate into the groundwater aquifer.

c (ii and iii)) The project has been reviewed by City Engineering staff for conformance with City ordinances and standards. The project includes adequate and appropriate facilities to ensure no net increase in the amount or rate of stormwater runoff from the site, and which will adequately convey stormwater flows.

c (iv) and e) The project has been reviewed by City Engineering staff for conformance with City ordinances and standards. The project is not located within either the Federal Emergency Management Agency floodplain or the City's Regulatory Floodplain (defined as the floodplain which will result from full buildout of the City). Therefore, the project will not impede or redirect flood flows, nor will it be inundated. The proposed project is located within an area of flat topography and is not near a waterbody or other feature which could cause a seiche or tsunami. There would be no impact with regard to these criterion.

XI. Land Use and Planning

The project site is within the City's Sierra Vista Specific Plan area, has a land use designation of CC, and a zoning designation of CC/SA. The proposed self-storage use requires a Use Permit within the CC/SA zone. The project is within a developing portion of the City surrounded by developing residential subdivisions, open space use, and commercial uses.

Would the project:

Environmental Issue	Potentially Significant Impact	Less Than Significant With Mitigation	Less Than Significant Impact	No Impact
a) Physically divide an established community?				X
b) Cause a significant environmental impact due to a conflict with any land use plan, policy, or regulation of an agency adopted for the purpose of avoiding or mitigating an environmental effect?				X

Thresholds of Significance and Regulatory Setting:

The significance of impacts related to land use is based directly on the CEQA Guidelines checklist items a and b listed above. Consistency with applicable City General Plan policies, Improvement Standards, and design standards is already required and part of the City's processing of permits and plans, so these requirements do not appear as mitigation measures.

Discussion of Checklist Answers:

a) The project area has been master planned for development, including adequate roads, pedestrian paths, and bicycle paths to provide connections within the community. The project will not physically divide an established community.

b) The proposed development is consistent with the existing neighborhood and does not conflict with policies or regulations adopted for the purpose of avoiding or mitigating an environmental impact. Impacts are less than significant.

XII. Mineral Resources

The Surface Mining and Reclamation Act (SMARA) of 1975 requires the State Geologist to classify land into Mineral Resource Zones (MRZ's) based on the known or inferred mineral resource potential of that land. The California Division of Mines and Geology (CDMG) was historically responsible for the classification and designation of areas containing—or potentially containing—significant mineral resources, though that

PC Exhibit A

INITIAL STUDY

October 15, 2020

SVSP PCL KT-43 – Baseline Storage – 5750 Baseline Road

File # PL19-0350

Page 30 of 44

responsibility now lies with the California Geological Survey (CGS). CDMG published Open File Report 95-10, which provides the mineral classification map for Placer County. A detailed evaluation of mineral resources has not been conducted within the City limits, but MRZ's have been identified. There are four broad MRZ categories (MRZ-1 through MRZ-4), and only MRZ-2 represents an area of known significant mineral resources. The City of Roseville General Plan EIR included Exhibit 4.1-3, depicting the location of MRZ's in the City limits. There is only one small MRZ-2 designation area, located at the far eastern edge of the City.

Would the project:

Environmental Issue	Potentially Significant Impact	Less Than Significant With Mitigation	Less Than Significant Impact	No Impact
a) Result in the loss of availability of a known mineral resource that would be of value to the region and the residents of the state?				X
b) Result in the loss of availability of a locally-important mineral resource recovery site delineated on a local general plan, specific plan or other land use plan?				X

Thresholds of Significance and Regulatory Setting:

The significance of impacts related to mineral resources is based directly on the CEQA Guidelines checklist items a and b listed above.

Discussion of Checklist Answers:

a–b) The project site is not in the area of the City known to include any mineral resources that would be of local, regional, or statewide importance; therefore, the project has no impacts on mineral resources.

XIII. Noise

The project consists of a self-storage facility with a manager' office and a caretaker unit. Potential sources of noise at the self-storage facilities include people talking, people moving items in and out of storage, and vehicles maneuvering through site. These noises are typical in residential and non-residential developments and do not generate substantial noise volumes. The nearest sensitive receptors will be the single-family residences located adjacent to the project's northern and eastern property boundaries. The proposed storage buildings will be designed so that the backside of the storage buildings will face the residential properties, which will shield these properties from noise generating activities. Additionally, an 8-foot tall masonry wall will be constructed along the portions of the property boundaries that are adjacent to residentially zoned properties.

PC Exhibit A

INITIAL STUDY

October 15, 2020

SVSP PCL KT-43 – Baseline Storage – 5750 Baseline Road

File # PL19-0350

Page 31 of 44

Would the project result in:

Environmental Issue	Potentially Significant Impact	Less Than Significant With Mitigation	Less Than Significant Impact	No Impact
a) Generation of a substantial temporary or permanent increase in ambient noise levels in the vicinity of the project in excess of standards established in the local general plan or noise ordinance, or applicable standards of other agencies?			X	
b) Generation of excessive ground borne vibration of ground borne noise levels?			X	
c) For a project located within the vicinity of a private airstrip or an airport land use plan or, where such a plan has not been adopted, within two miles of a public airport or public use airport, would the project expose people residing or working in the project area to excessive noise levels?				X

Thresholds of Significance and Regulatory Setting:

Standards for transportation noise and non-transportation noise affecting existing or proposed land uses are established within the City of Roseville General Plan Noise Element Table IX-1 and IX-3, and these standards are used as the thresholds to determine the significance of impacts related to items a and c. The significance of other noise impacts is based directly on the CEQA Guidelines checklist items b and c listed above. The Findings of the Implementing Procedures indicate that compliance with the City Noise Regulation (RMC Ch. 9.24) will prevent significant non-transportation noise as it relates to items a and b. The Ordinance establishes noise exposure standards that protect noise-sensitive receptors from a variety of noise sources, including non-transportation/fixed noise, amplified sound, industrial noise, and events on public property. The project is not within an airport land use plan, within two miles of a public or public use airport and there are also no private airstrips in the vicinity of the project area. Therefore, item c has been ruled out from further analysis.

Discussion of Checklist Answers:

a) The City's Noise Ordinance includes sound limits for sensitive receptors. Section 9.24.100 states that noise measured at the property line of a sensitive receptor shall not exceed the ambient sound level by 3 dBA, or exceed the sound level standard in Table 1 (Figure 3), whichever is greater.

The subject property is surrounded by residentially designated properties to the north and east. The proposed project is designed with the backs of the storage units toward the residential properties and masonry walls will be constructed along these property boundaries. The hours of operation will be limited to between 7:00 am and

7:00 pm on weekdays and between 8:00 am and 8:00 pm on Saturday, Sunday, and holidays. These design and operational features will create a noise buffer between the users of the storage facility and the residential properties. Additionally, storage facilities are not considered substantial noise generating uses.

The project is subject to the commercial noise reduction mitigation measures found in the SVSP. These measures require a 6-7 foot masonry wall where commercial uses adjoin residential property lines and include specific requirements for commercial uses that include loading docks or truck circulation routes facing residential areas. The project includes masonry walls on the property boundaries adjacent to residential properties consistent with the SVSP mitigation requirements. The project does not include loading docks or truck routes and will not generate noise that that will exceed City standards at the property lines of the adjacent residential properties. Impacts related to noise generated from the proposed project are less than significant.

Figure 3: Noise Ordinance Table 1

Table 1 SOUND LEVEL STANDARDS (for non-transportation or fixed sound sources)		
Sound Level Descriptor	Daytime (7:00 a.m. to 10:00 p.m.)	Nighttime (10:00 p.m. to 7:00 a.m.)
Hourly L_{eq} , dB	50	45
Maximum level, dB	70	65

A. Each of the sound level standards specified in Table 1 shall be reduced by five dB for simple tone noises, consisting of speech and music. However, in no case shall the sound level standard be lower than the ambient sound level plus three dB.

B. If the intruding sound source is continuous and cannot reasonably be discontinued or stopped for a time period whereby the ambient sound level can be measured, the sound level measured while the source is in operation shall be compared directly to the sound level standards of Table 1. (Ord. 3638 § 1, 2001.)

b) Surrounding uses may experience short-term increases in groundborne vibration, groundborne noise, and airborne noise levels during construction. However, these increases would only occur for a short period of time. When conducted during daytime hours, construction activities are exempt from Noise Ordinance standards, but the standards do apply to construction occurring during nighttime hours. While the noise generated may be a minor nuisance, the City Noise Regulation standards are designed to ensure that impacts are not unduly intrusive. Based on this, the impact is less than significant.

XIV. Population and Housing

The project site is located within the SVSP and has a land use designation of GC/SA. The City of Roseville General Plan Table II-4 identifies the total number of residential units and population anticipated as a result of

PC Exhibit A

INITIAL STUDY

October 15, 2020

SVSP PCL KT-43 – Baseline Storage – 5750 Baseline Road

File # PL19-0350

Page 33 of 44

buildout of the City, and the Specific Plan likewise includes unit allocations and population projections for the Plan Area. No housing was anticipated for the project site.

Would the project:

Environmental Issue	Potentially Significant Impact	Less Than Significant With Mitigation	Less Than Significant Impact	No Impact
a) Induce substantial unplanned population growth in an area, either directly (for example, by proposing new homes and businesses) or indirectly (for example, through extension of roads or other infrastructure)?			X	
b) Displace substantial numbers of existing people or housing, necessitating the construction of replacement housing elsewhere?			X	

Thresholds of Significance and Regulatory Setting:

The significance of impacts related to population and housing is based directly on the CEQA Guidelines checklist items a and b listed above.

Discussion of Checklist Answers:

a) The CEQA Guidelines identify several ways in which a project could have growth-inducing impacts (Public Resources Code Section 15126.2), either directly or indirectly. Growth-inducement may be the result of fostering economic growth, fostering population growth, providing new housing, or removing barriers to growth. Growth inducement may be detrimental, beneficial, or of no impact or significance under CEQA. An impact is only deemed to occur when it directly or indirectly affects the ability of agencies to provide needed public services, or if it can be shown that the growth will significantly affect the environment in some other way. The project is consistent with the land use designation of the site. Therefore, while the project in question will induce some level of growth, this growth was already identified and its effects disclosed and mitigated within the SVSP EIR. Therefore, the impact of the project is less than significant.

b) The project site is vacant. No housing exists on the project site, and there would be no impact with respect to these criteria.

XV. Public Services

Fire protection, police protection, park services, and library services are provided by the City. Would the project result in substantial adverse physical impacts associated with the provision of new or physically altered governmental facilities, need for new or physically altered government facilities, the construction of which could

PC Exhibit A

INITIAL STUDY

October 15, 2020

SVSP PCL KT-43 – Baseline Storage – 5750 Baseline Road

File # PL19-0350

Page 34 of 44

cause significant environmental impacts, in order to maintain acceptable service ratios, response times or other performance objectives for any of the following public services:

Environmental Issue	Potentially Significant Impact	Less Than Significant With Mitigation	Less Than Significant Impact	No Impact
a) Fire protection?			X	
b) Police protection?			X	
c) Schools?				X
d) Parks?				X
e) Other public facilities?				X

Thresholds of Significance and Regulatory Setting:

The significance of impacts related to public services is based directly on the CEQA Guidelines checklist items a–e listed above. The EIR for the SVSP addressed the level of public services which would need to be provided in order to serve planned growth in the community. Development Agreements and other conditions have been adopted in all proposed growth areas of the City which identify the physical facilities needed to serve growth, and the funding needed to provide for the construction and operation of those facilities and services; the project is consistent with the SVSP. In addition, the project has been routed to the various public service agencies, both internal and external, to ensure that the project meets the agencies' design standards (where applicable) and to provide an opportunity to recommend appropriate conditions of approval.

Discussion of Checklist Answers:

a) Existing City codes and regulations require adequate water pressure in the water lines, and construction must comply with the Uniform Fire and Building Codes used by the City of Roseville. Additionally, the applicant is required to pay a fire service construction tax, which is used for purchasing capital facilities for the Fire Department. Existing codes, regulations, funding agreements, and facilities plans are sufficient to ensure less than significant impacts.

b) Pursuant to the Development Agreement for the project area, the developer is required to pay fees into a Community Facilities District, which provides funding for police services. Sales taxes and property taxes resulting from the development will add revenue to the General Fund, which also serves to fund police services. Existing codes, regulations, funding agreements, and facilities plans are sufficient to ensure less than significant impacts.

c) The applicant for this project is required to pay school impact fees at a rate determined by the local school districts. School fees will be collected prior to the issuance of building permits, consistent with City requirements. School sites have already been designated as part of the Specific Plan process. Existing codes, regulations, funding agreements, and facilities plans are sufficient to ensure less than significant impacts.

d) Pursuant to the Development Agreement for the project area, the developer will be required to pay fees into a Community Facilities District, which provides funding for park services. Future park and recreation sites and facilities have already been identified as part of the Specific Plan process. Existing codes, regulations, funding agreements, and facilities plans are sufficient to ensure less than significant impacts.

e) Pursuant to the Development Agreement for the project area, the developer will be required to pay fees into a Community Facilities District, which provides funding for the library system and other such facilities and services. In addition, the City charges fees to end-users for other services, such as garbage and greenwaste

PC Exhibit A

INITIAL STUDY

October 15, 2020

SVSP PCL KT-43 – Baseline Storage – 5750 Baseline Road

File # PL19-0350

Page 35 of 44

collection, in order to fund those services. Existing codes, regulations, funding agreements, and facilities plans are sufficient to ensure less than significant impacts.

XVI. Recreation

The project is in a developing part of the City with no existing parks within the vicinity of the subject property. There are parks planned northeast and northwest of the site and the site is adjacent to planned open space.

Would the project:

Environmental Issue	Potentially Significant Impact	Less Than Significant With Mitigation	Less Than Significant Impact	No Impact
a) Would the project increase the use of existing neighborhood and regional parks or other recreational facilities such that physical deterioration of the facility would occur or be accelerated?				X
b) Does the project include recreational facilities or require the construction or expansion of recreational facilities which might have an adverse physical effect on the environment?				X

Thresholds of Significance and Regulatory Setting:

The significance of impacts related to recreation services is based directly on the CEQA Guidelines checklist items a–b listed above.

Discussion of Checklist Answers:

a) The EIR for the SVSP addressed the level of park services—including new construction, maintenance, and operations—which would need to be provided in order to serve planned growth in the community. Given that the project is consistent with the General Plan and Specific Plan, the project would not cause any unforeseen or new impacts related to the use of existing or proposed parks and recreational facilities. Existing codes, regulations, funding agreements, and facilities plans are sufficient to ensure less than significant impacts.

b) Park sites and other recreational facilities were identified within the SVSP, and the plan-level impacts of developing those facilities were addressed within the Final EIR for the SVSP. The project will not cause any unforeseen or new impacts related to the construction or expansion of recreational facilities.

XVII. Transportation

The project is located on the northern side of Baseline Road. Baseline Road is a two-lane east/west roadway in this portion of the City and is planned to be constructed as a six-lane arterial in the future. The expansion of Baseline Road is not within the scope of this project. The proposed project will be accessed directly from Baseline Road from a new driveway that will be constructed with the project. The project includes frontage improvements, including landscaping adjacent to Baseline Road.

PC Exhibit A

INITIAL STUDY

October 15, 2020

SVSP PCL KT-43 – Baseline Storage – 5750 Baseline Road

File # PL19-0350

Page 36 of 44

Would the project:

Environmental Issue	Potentially Significant Impact	Less Than Significant With Mitigation	Less Than Significant Impact	No Impact
a) Conflict with a program, plan, ordinance or policy addressing the circulation system, including transit, roadway, bicycle, and pedestrian facilities?			X	
b) Conflict or be inconsistent with CEQA Guidelines Section 15064.3, subdivision (b)?			X	
c) Substantially increase hazards due to a geometric design feature(s) (e.g., sharp curves or dangerous intersections) or incompatible uses (e.g., farm equipment)?			X	
d) Result in inadequate emergency access?			X	

Thresholds of Significance and Regulatory Setting:

CEQA Guidelines Section 15064.3 indicates that a project's effect on automobile delay cannot be considered a significant impact, and directs transportation system analysis to focus on vehicle miles traveled (VMT), per checklist item b. However, the CEQA Guidelines also include consistency with a program, plan, or policy addressing transportation systems as an area of potential environmental effects (checklist item a). The City has adopted the following plans, ordinances, or policies applicable to this checklist item: Pedestrian Master Plan, Bicycle Master Plan, and Short-Range Transit Plan, and Updated General Plan Circulation Element. The project is evaluated for consistencies with these plans and the policies contained within them, which includes an analysis of delay. The Updated Circulation Element of the General Plan establishes Level of Service C or better as an acceptable operating condition at all signalized intersections during a.m. and p.m. peak hours. Exceptions to this policy may be made by the City Council, but a minimum of 70% of all signalized intersections must maintain LOS C. The Findings of the Implementing Procedures indicate that compliance with the Traffic Mitigation Fee (RMC Ch. 4.44) will fund roadway projects and improvements necessary to maintain the City's Level of Service standards for projects consistent with the General Plan and related Specific Plan. An existing plus project conditions (short-term) traffic impact study may be required for projects with unique trip generation or distribution characteristics, in areas of local traffic constraints, or to study the proposed project access. A cumulative plus project conditions (long-term) study is required if a project is inconsistent with the General Plan or Specific Plan and would generate more than 50 pm peak-hour trips. The guidelines for traffic study preparation are found in the City of Roseville Design and Construction Standards--Section 4.

For checklist item b, the CEQA Guidelines Section 15064.3 establishes a detailed process for evaluating the significance of transportation impacts. In accordance with this section, the analysis must focus on the generation

of vehicle miles traveled (VMT). Projects within one-half mile of either an existing major transit stop⁵ or a stop along an existing high quality transit corridor⁶ should be presumed to have less than significant impacts, as should any project which will decrease VMT when compared with the existing conditions. VMT may be analyzed qualitatively if existing models or methods are not available to estimate VMT for a particular project; this will generally be appropriate for discussions of construction traffic VMT.

Impacts with regard to items c and d are assessed based on the expert judgment of the City Engineer and City Fire Department, as based upon facts and consistency with the City's Design and Construction Standards.

Discussion of Checklist Answers:

a) The project was reviewed by the City's Engineering Division for consistency with the buildout assumptions in the SVSP and the City's General Plan. The project is located in an area planned for commercial uses along the northern side of Baseline Road west of Fiddymont Road. The project is in an area that is currently developing. Adjacent to the project site Baseline Road is currently developed as a two lane road, but is planned to be expanded to six lanes. Development of Baseline Road is not within the scope of this project. The proposed project will be constructed consistent with the planned roadway system and in compliance with the requirements of the SVSP and the General Plan.

b) Traffic analyses focus on the number of trips traveling in specified areas during peak periods, in order to quantify impacts at specific intersections. However, there is no direct relationship between the number of trips and the amount of VMT generated by a use. Projects which substantially increase trips to a specific area may in fact decrease VMT in the City. As an example, if a new grocery store is added to an area, customers who go to that store were already going to a grocery store elsewhere, and are most likely to choose the new store because it is closer to home or on their way to another location (e.g. work). So while the store would generate substantial new trips, it would lower Citywide VMT. Unless a project includes unique characteristics, non-residential projects do not increase VMT; they divert existing trips into a similar or more efficient pathway.

According to the Governor's Office of Planning and Research (OPR) Technical Advisory on Evaluating Transportation Impacts in CEQA (Technical Advisory), "new retail development typically redistributes shopping trips rather than creating new trips," and most importantly:

"By adding retail opportunities into the urban fabric and thereby improving retail destination proximity, local-serving retail development tends to shorten trips and reduce VMT. Thus, lead agencies generally may presume such development creates a less-than-significant transportation impact."

In other words, the Technical Advisory indicates that local-serving retail (and other commercial uses) generally redistributes trips in a manner that reduces VMT compared to the existing baseline. The project is local-serving commercial, as defined in the City's General Plan^[1] and based on an evaluation of the specific site setting. The proposed project is a non-residential development, surrounded by a developing community. The project does not include any unique characteristics which would draw in regional traffic, or that would prompt longer trips. The project would serve the surrounding developing community, and would therefore have a neutral or positive affect on vehicle miles traveled. Impacts are less than significant.

⁵ A site containing an existing rail transit station, a ferry terminal served by either a bus or rail transit service, or the intersection of two or more major bus routes with a frequency of service interval of 15 minutes or less during the morning and afternoon peak commute periods. (Public Resources Code Section 21064.3)

⁶ A corridor with fixed route bus service at service intervals of 15 minutes or less during peak commute hours.

^[1] Regional-serving retail is permitted within the City's Regional Commercial land use designation, and is defined by the General Plan as "major department and discount stores, automalls, hotels and motels, and commercial recreation or entertainment." The project does not include any of these uses, and moreover, the site is designated Community Commercial, not Regional Commercial.

PC Exhibit A

INITIAL STUDY

October 15, 2020

SVSP PCL KT-43 – Baseline Storage – 5750 Baseline Road

File # PL19-0350

Page 38 of 44

c, d) The project has been reviewed by the City Engineering and City Fire Department staff, and has been found to be consistent with the City’s Design Standards. Furthermore, standard conditions of approval added to all City project require compliance with Fire Codes and other design standards. Compliance with existing regulations ensure that impacts are less than significant.

XVIII. Tribal Cultural Resources

As described within the Open Space and Conservation Element of the City of Roseville General Plan, the Roseville region was within the territory of the Nisenan (also Southern Maidu or Valley Maidu). Two large permanent Nisenan habitation sites have been identified and protected within the City’s open space (in Maidu Park). Numerous smaller cultural resources, such as midden deposits and bedrock mortars, have also been recorded in the City. A majority of documented sites within the City are located in areas designated for open space uses.

Would the project cause a substantial adverse change in the significance of a Tribal Cultural Resource as defined in Public Resources Code Section 21074 as either a site, feature, place, cultural landscape that is geographically defined in terms of the size and scope of the landscape, sacred place, or object with cultural value to a California Native American tribe, and that is:

Environmental Issue	Potentially Significant Impact	Less Than Significant With Mitigation	Less Than Significant Impact	No Impact
a) Listed or eligible for listing in the California Register of Historical Resources, or in a local register of historical resources as defined in Public Resources Code section 5020.1(k)?			X	
b) A resource determined by the lead agency, in its discretion and supported by substantial evidence, to be significant pursuant to criteria set forth in subdivision (c) of Public Resources Code Section 5024.1? In applying the criteria set forth in subdivision (c) of Public Resources Code Section 5024.1 the lead agency shall consider the significance of the resource to a California Native American tribe.			X	

Thresholds of Significance and Regulatory Setting:

In addition to archeological resources, tribal cultural resources are also given particular treatment. Tribal cultural resources are defined in Public Resources Code Section 21074, as either 1) a site, feature, place, geographically-defined cultural landscape, sacred place, or object with cultural value to a California Native American Tribe, that is listed or eligible for listing on the California Register or Historical Resources, or on a local

register of historical resources or as 2) a resource determined by the lead agency, supported by substantial evidence, to be significant according to the historical register criteria in Public Resources Code section 5024.1(c), and considering the significance of the resource to a California Native American Tribe.

Discussion of Checklist Answers:

a) The SVSP EIR included historic and cultural resources study, which included research on whether any listed or eligible sites had been documented in the project area. No such sites were found. However, a standard mitigation measure applies which is designed to reduce impacts to any previously undiscovered resources, should any be found on-site. The measure requires an immediate cessation of work, and contact with the appropriate agencies to address the resource before work can resume. The project will not result in any new impacts beyond those already discussed and disclosed in the SVSP EIR; project-specific impacts are less than significant.

b) Notice of the proposed project was mailed to tribes which had requested such notice pursuant to AB 52. On June 2, 2020, a consultation request was received from the United Auburn Indian Community (UAIC), which included a request for all cultural resource survey work that had been conducted and inclusion of a mitigation measure to document processes in the event of an unanticipated discovery. The UAIC further requested an opportunity to review and comment on the project’s CEQA documentation. Staff provided the analysis that was previously prepared for the SVSP and agreed to the requested mitigation measure. No further requests were received as of the writing of this document. As discussed in the Cultural Resources section of this document, the project is subject to MM 4.9-1 of the SVSP MMRP as detailed in the Table of Applicable Mitigation Measures (Attachment 2). As discussed in item a, above, no resources are known to occur in the area. However, mitigation measures apply which are designed to reduce impacts to resources, should any be found on-site. The measure requires an immediate cessation of work, and contact with the appropriate agencies to address the resource before work can resume. This measure meets the objective of the UAIC request. The project will not result in any new impacts beyond those already discussed and disclosed in the SVSP EIR; project-specific impacts are less than significant.

XIX. Utilities and Service Systems

The project site is located within a developed area with the major utility infrastructure already installed, consistent with the SVSP. Existing sewer systems, stormwater treatment facilities, and water facilities are available to serve the project site.

Would the project:

Environmental Issue	Potentially Significant Impact	Less Than Significant With Mitigation	Less Than Significant Impact	No Impact
a) Require or result in the relocation or construction of new or expanded water, wastewater treatment or storm water drainage, electric power, natural gas, or telecommunications facilities, the construction or relocation of which could cause significant environmental effects?			X	

PC Exhibit A

INITIAL STUDY

October 15, 2020

SVSP PCL KT-43 – Baseline Storage – 5750 Baseline Road

File # PL19-0350

Page 40 of 44

Environmental Issue	Potentially Significant Impact	Less Than Significant With Mitigation	Less Than Significant Impact	No Impact
b) Have sufficient water supplies available to serve the project and reasonably foreseeable future development during normal, dry, and multiple dry years?			X	
c) Result in a determination by the wastewater treatment provider which serves the project that it has adequate capacity to serve the project's projected demand in addition of the provider's existing commitments?			X	
d) Generate solid waste in excess of State or local standards, or in excess of the capacity of local infrastructure, or otherwise impair the attainment of solid waste reduction goals?			X	
e) Comply with federal, state, and local management and reduction statutes and regulations related to solid waste?			X	

Thresholds of Significance and Regulatory Setting:

The significance of impacts related to utilities and service systems is based directly on the CEQA Guidelines checklist items a–e listed above.

Discussion of Checklist Answers:

a) The project is consistent with the Specific Plan, and will be required to construct any utilities infrastructure necessary to serve the project, as well as pay fees which fund the operation of the facilities and the construction of major infrastructure. The construction impacts related to building the major infrastructure were disclosed in the EIR for the Specific Plan, and appropriate mitigation was adopted. Minor additional infrastructure will be constructed within the project site to tie the project into the major systems, but these facilities will be constructed in locations where site development is already occurring as part of the overall project; there are no additional substantial impacts specific or particular to the minor infrastructure improvements.

b) The City of Roseville 2015 Urban Water Management Plan (UWMP), adopted May 2016, estimates water demand and supply for the City through the year 2040, based on existing land use designations and population projections. In addition, the Amoruso Ranch Water Supply Assessment (AR WSA, Appendix E of the Amoruso Ranch FEIR), dated May 2016, estimates water demand and supply for ultimate General Plan buildout. The

PC Exhibit A

INITIAL STUDY

October 15, 2020

SVSP PCL KT-43 – Baseline Storage – 5750 Baseline Road

File # PL19-0350

Page 41 of 44

project is consistent with existing land use designations, and is therefore consistent with the assumptions of the UWMP and AR WSA. The UWMP indicates that existing water supply sources are sufficient to meet all near term needs, estimating an annual water demand of 45,475 acre-feet per year (AFY) by the year 2020 and existing surface and recycled water supplies in the amount of 70,421 AFY. The AR WSA estimates a Citywide buildout demand of 64,370 AFY when including recycled water, and of 59,657 AFY of potable water. The AR WSA indicates that surface water supply is sufficient to meet demand during normal rainfall years, but is insufficient during single- and multiple-dry years. However, the City's UWMP establishes mandatory water conservation measures and the use of groundwater to offset reductions in surface water supplies. Both the UWMP and AR WSA indicate that these measures, in combination with additional purchased water sources, will ensure that supply meets projected demand. The project, which is consistent with existing land use designations, would not require new or expanded water supply entitlements.

c) The proposed project would be served by the Pleasant Grove Wastewater Treatment Plant (PGWWTP). The Central Valley Regional Water Quality Control Board (RWQCB) regulates water quality and quantity of effluent discharged from the City's wastewater treatment facilities. The Pleasant Grove WWTP has the capacity⁷ to treat 12 million gallons per day (mgd) and is currently treating 7.0⁸ mgd. The project is consistent with existing land use designations, which is how infrastructure capacity is planned. Therefore, the volume of wastewater generated by the proposed project could be accommodated by the facility; the proposed project will not contribute to an exceedance of applicable wastewater treatment requirements. The impact would be less than significant.

d, e) The Western Placer Waste Management Authority is the regional agency handling recycling and waste disposal for Roseville and surrounding areas. The regional waste facilities include a Material Recovery Facility (MRF) and the Western Regional Sanitary Landfill (WRSL). Currently, the WRSL is permitted to accept up to 1,900 tons of municipal solid waste per day. According to the solid waste analysis of the Amoruso Ranch Specific Plan FEIR, under current projected development conditions the WRSL has a projected lifespan extending through 2058. There is sufficient existing capacity to serve the proposed project. Though the project will contribute incrementally to an eventual need to find other means of waste disposal, this impact of City buildout has already been disclosed and mitigation applied as part of each Specific Plan the City has approved, including the most recent Amoruso Ranch Specific Plan. All residences and business in the City pay fees for solid waste collection, a portion of which is collected to fund eventual solid waste disposal expansion. The project will not result in any new impacts associated with major infrastructure. Environmental Utilities staff has reviewed the project for consistency with policies, codes, and regulations related to waste disposal and waste reduction regulations and policies and has found that the project design is in compliance.

XX. Wildfire

If located in or near state responsibility areas or lands classified as very high fire hazard severity zones, would the project:

Environmental Issue	Potentially Significant Impact	Less Than Significant With Mitigation	Less Than Significant Impact	No Impact
a) Substantially impair an adopted emergency response plan or emergency evacuation plan?				X

⁷ Waste Discharge Requirements/Monitoring & Reporting Program/NPDES Permit No. CA0079502, Adopted on 28 March 2014

⁸ Dave Samuelson, City of Roseville Environmental Utilities, Personal communication, July 6, 2016.

PC Exhibit A

INITIAL STUDY

October 15, 2020

SVSP PCL KT-43 – Baseline Storage – 5750 Baseline Road

File # PL19-0350

Page 42 of 44

Environmental Issue	Potentially Significant Impact	Less Than Significant With Mitigation	Less Than Significant Impact	No Impact
b) Due to slope, prevailing winds, and other factors, exacerbate wildfire risks, and thereby expose project occupants to pollutant concentrations from a wildfire or the uncontrolled spread of a wildfire?				X
c) Require the installation or maintenance of associated infrastructure (such as roads, fuel breaks, emergency water sources, power lines or other utilities) that may exacerbate fire risk or that may result in temporary or ongoing impacts to the environment?				X
d) Expose people or structures to significant risks, including downslope or downstream flooding or landslides, as a result of runoff, post-fire slope instability, or drainage changes?				X

Thresholds of Significance and Regulatory Setting:

The significance of impacts related to wildfire is based directly on the CEQA Guidelines checklist items a–d listed above. The California Department of Forestry and Fire Protection (CAL FIRE) is the state agency responsible for wildland fire protection and management. As part of that task, CAL FIRE maintains maps designating Wildland Fire Hazard Severity zones. The City is not located within a Very High Fire Hazard Severity Zone, and is not in a CAL FIRE responsibility area; fire suppression is entirely within local responsibility.

Discussion of Checklist Answers:

a–d) Checklist questions a–d above do not apply, because the project site is not within a Very High Fire Hazard Severity Zone and is not in a CAL FIRE responsibility area.

XXI. Mandatory Findings of Significance

Environmental Issue	Potentially Significant Impact	Less Than Significant With Mitigation	Less Than Significant Impact	No Impact
a) Does the project have the potential to degrade the quality of the environment, substantially reduce the			X	

PC Exhibit A

INITIAL STUDY

October 15, 2020

SVSP PCL KT-43 – Baseline Storage – 5750 Baseline Road

File # PL19-0350

Page 43 of 44

Environmental Issue	Potentially Significant Impact	Less Than Significant With Mitigation	Less Than Significant Impact	No Impact
habitat of a fish or wildlife species, cause a fish or wildlife population to drop below self-sustaining levels, threaten to eliminate a plant or animal community, substantially reduce the number or restrict the range of an endangered, threatened or rare species, or eliminate important examples of the major periods of California history or prehistory?				
b) Does the project have impacts which are individually limited, but cumulatively considerable? (“Cumulatively considerable” means that the incremental effects of a project are considerable when viewed in connection with the effects of past projects, the effects of other current projects, and the effects of probable future projects.)			X	
c) Does the project have environmental effects which will cause substantial adverse effects on human beings, either directly or indirectly?			X	

Significance Criteria and Regulatory Setting:

The significance of impacts related to mandatory findings of significance is based directly on the CEQA Guidelines checklist items a–c listed above.

Discussion of Checklist Answers:

a–c) Long term environmental goals are not impacted by the proposed project. The cumulative impacts do not deviate beyond what was contemplated in the Specific Plan EIR, and mitigation measures have already been incorporated via the Specific Plan EIR. With implementation of the City’s Mitigating Ordinances, Guidelines, and Standards and best management practices, mitigation measures described in this chapter, and permit conditions, the proposed project will not have a significant impact on the habitat of any plant or animal species. Based on the foregoing, the proposed project does not have the potential to degrade the quality of the environment, substantially reduce the habitat of any wildlife species, or create adverse effects on human beings.

PC Exhibit A

ENVIRONMENTAL DETERMINATION:

*In reviewing the site specific information provided for this project and acting as Lead Agency, the City of Roseville, Development Services Department, Planning Division has analyzed the potential environmental impacts created by this project and determined that the impacts are less than significant. As demonstrated in the initial study checklist, there are no "project specific significant effects which are peculiar to the project or site" that cannot be reduced to less than significant effects through mitigation (CEQA Section 15183) and therefore an EIR is not required. Therefore, **on the basis of the foregoing initial study:***

STAFF TO DELETE INAPPLICABLE STATEMENT

I find that the proposed project WILL NOT have a significant effect on the environment and a *NEGATIVE DECLARATION* has been prepared.

Initial Study Prepared by:

Charity Gold

Charity Gold, Associate Planner
City of Roseville, Development Services – Planning Division

Attachments:

1. CalEEMod Annual Calculation, July 16, 2020
2. Table of Applicable Mitigation Measures

Baseline Storage - Placer County APCD Air District, Annual

Baseline Storage
Placer County APCD Air District, Annual

1.0 Project Characteristics

1.1 Land Usage

Land Uses	Size	Metric	Lot Acreage	Floor Surface Area	Population
Other Non-Asphalt Surfaces	163.00	1000sqft	3.74	163,000.00	0
General Light Industry	67.00	1000sqft	1.54	67,000.00	0

1.2 Other Project Characteristics

Urbanization	Urban	Wind Speed (m/s)	2.2	Precipitation Freq (Days)	74
Climate Zone	2			Operational Year	2022
Utility Company	Roseville Electric				
CO2 Intensity (lb/MW hr)	793.8	CH4 Intensity (lb/MW hr)	0.029	N2O Intensity (lb/MW hr)	0.006

1.3 User Entered Comments & Non-Default Data

Project Characteristics -
 Land Use -
 Construction Phase -

Table Name	Column Name	Default Value	New Value
------------	-------------	---------------	-----------

2.0 Emissions Summary

Baseline Storage - Placer County APCD Air District, Annual

Quarter	Start Date	End Date	Maximum Unmitigated ROG + NOX (tons/quarter)	Maximum Mitigated ROG + NOX (tons/quarter)
1	7-16-2020	10-15-2020	0.7306	0.7306
2	10-16-2020	1-15-2021	0.8601	0.8601
3	1-16-2021	4-15-2021	0.7759	0.7759
4	4-16-2021	7-15-2021	0.7826	0.7826
5	7-16-2021	9-30-2021	0.6511	0.6511
		Highest	0.8601	0.8601

2.2 Overall Operational

Unmitigated Operational

	ROG	NOx	CO	SO2	Fugitive PM10	Exhaust PM10	PM10 Total	Fugitive PM2.5	Exhaust PM2.5	PM2.5 Total	Bio- CO2	NBio- CO2	Total CO2	CH4	N2O	CO2e
Category	tons/yr										MT/yr					
Area	0.3057	2.0000e-005	2.1200e-003	0.0000		1.0000e-005	1.0000e-005		1.0000e-005	1.0000e-005	0.0000	4.1100e-003	4.1100e-003	1.0000e-005	0.0000	4.3800e-003
Energy	6.7300e-003	0.0612	0.0514	3.7000e-004		4.6500e-003	4.6500e-003		4.6500e-003	4.6500e-003	0.0000	270.4939	270.4939	8.7200e-003	2.7600e-003	271.5353
Mobile	0.1065	0.7717	1.2523	5.0400e-003	0.3829	4.2600e-003	0.3871	0.1030	4.0100e-003	0.1070	0.0000	463.8779	463.8779	0.0173	0.0000	464.3111
Waste						0.0000	0.0000		0.0000	0.0000	16.8645	0.0000	16.8645	0.9967	0.0000	41.7811
Water						0.0000	0.0000		0.0000	0.0000	4.9155	30.1864	35.1018	0.5060	0.0122	51.3714
Total	0.4189	0.8330	1.3058	5.4100e-003	0.3829	8.9200e-003	0.3918	0.1030	8.6700e-003	0.1117	21.7799	764.5622	786.3422	1.5287	0.0149	829.0032

Baseline Storage - Placer County APCD Air District, Annual

2.2 Overall Operational

Mitigated Operational

	ROG	NOx	CO	SO2	Fugitive PM10	Exhaust PM10	PM10 Total	Fugitive PM2.5	Exhaust PM2.5	PM2.5 Total	Bio- CO2	NBio- CO2	Total CO2	CH4	N2O	CO2e
Category	tons/yr										MT/yr					
Area	0.3057	2.0000e-005	2.1200e-003	0.0000		1.0000e-005	1.0000e-005		1.0000e-005	1.0000e-005	0.0000	4.1100e-003	4.1100e-003	1.0000e-005	0.0000	4.3800e-003
Energy	6.7300e-003	0.0612	0.0514	3.7000e-004		4.6500e-003	4.6500e-003		4.6500e-003	4.6500e-003	0.0000	270.4939	270.4939	8.7200e-003	2.7600e-003	271.5353
Mobile	0.1065	0.7717	1.2523	5.0400e-003	0.3829	4.2600e-003	0.3871	0.1030	4.0100e-003	0.1070	0.0000	463.8779	463.8779	0.0173	0.0000	464.3111
Waste						0.0000	0.0000		0.0000	0.0000	16.8645	0.0000	16.8645	0.9967	0.0000	41.7811
Water						0.0000	0.0000		0.0000	0.0000	4.9155	30.1864	35.1018	0.5060	0.0122	51.3714
Total	0.4189	0.8330	1.3058	5.4100e-003	0.3829	8.9200e-003	0.3918	0.1030	8.6700e-003	0.1117	21.7799	764.5622	786.3422	1.5287	0.0149	829.0032

	ROG	NOx	CO	SO2	Fugitive PM10	Exhaust PM10	PM10 Total	Fugitive PM2.5	Exhaust PM2.5	PM2.5 Total	Bio- CO2	NBio-CO2	Total CO2	CH4	N2O	CO2e
Percent Reduction	0.00	0.00	0.00	0.00	0.00	0.00	0.00	0.00	0.00	0.00	0.00	0.00	0.00	0.00	0.00	0.00

3.0 Construction Detail

Construction Phase

Baseline Storage - Placer County APCD Air District, Annual

Phase Number	Phase Name	Phase Type	Start Date	End Date	Num Days Week	Num Days	Phase Description
1	Site Preparation	Site Preparation	8/13/2020	8/26/2020	5	10	
2	Grading	Grading	8/27/2020	9/23/2020	5	20	
3	Building Construction	Building Construction	9/24/2020	8/11/2021	5	230	
4	Paving	Paving	8/12/2021	9/8/2021	5	20	
5	Architectural Coating	Architectural Coating	9/9/2021	10/6/2021	5	20	

Acres of Grading (Site Preparation Phase): 0

Acres of Grading (Grading Phase): 10

Acres of Paving: 3.74

Residential Indoor: 0; Residential Outdoor: 0; Non-Residential Indoor: 100,500; Non-Residential Outdoor: 33,500; Striped Parking Area: 9,780 (Architectural Coating – sqft)

OffRoad Equipment

Baseline Storage - Placer County APCD Air District, Annual

Phase Name	Offroad Equipment Type	Amount	Usage Hours	Horse Power	Load Factor
Architectural Coating	Air Compressors	1	6.00	78	0.48
Grading	Excavators	1	8.00	158	0.38
Building Construction	Cranes	1	7.00	231	0.29
Building Construction	Forklifts	3	8.00	89	0.20
Building Construction	Generator Sets	1	8.00	84	0.74
Paving	Pavers	2	8.00	130	0.42
Paving	Rollers	2	8.00	80	0.38
Grading	Rubber Tired Dozers	1	8.00	247	0.40
Building Construction	Tractors/Loaders/Backhoes	3	7.00	97	0.37
Grading	Graders	1	8.00	187	0.41
Grading	Tractors/Loaders/Backhoes	3	8.00	97	0.37
Paving	Paving Equipment	2	8.00	132	0.36
Site Preparation	Tractors/Loaders/Backhoes	4	8.00	97	0.37
Site Preparation	Rubber Tired Dozers	3	8.00	247	0.40
Building Construction	Welders	1	8.00	46	0.45

Trips and VMT

Phase Name	Offroad Equipment Count	Worker Trip Number	Vendor Trip Number	Hauling Trip Number	Worker Trip Length	Vendor Trip Length	Hauling Trip Length	Worker Vehicle Class	Vendor Vehicle Class	Hauling Vehicle Class
Site Preparation	7	18.00	0.00	0.00	10.80	7.30	20.00	LD_Mix	HDT_Mix	HHDT
Grading	6	15.00	0.00	0.00	10.80	7.30	20.00	LD_Mix	HDT_Mix	HHDT
Building Construction	9	97.00	38.00	0.00	10.80	7.30	20.00	LD_Mix	HDT_Mix	HHDT
Paving	6	15.00	0.00	0.00	10.80	7.30	20.00	LD_Mix	HDT_Mix	HHDT
Architectural Coating	1	19.00	0.00	0.00	10.80	7.30	20.00	LD_Mix	HDT_Mix	HHDT

3.1 Mitigation Measures Construction

Baseline Storage - Placer County APCD Air District, Annual

3.2 Site Preparation - 2020

Unmitigated Construction On-Site

	ROG	NOx	CO	SO2	Fugitive PM10	Exhaust PM10	PM10 Total	Fugitive PM2.5	Exhaust PM2.5	PM2.5 Total	Bio- CO2	NBio- CO2	Total CO2	CH4	N2O	CO2e
Category	tons/yr										MT/yr					
Fugitive Dust					0.0903	0.0000	0.0903	0.0497	0.0000	0.0497	0.0000	0.0000	0.0000	0.0000	0.0000	0.0000
Off-Road	0.0204	0.2121	0.1076	1.9000e-004		0.0110	0.0110		0.0101	0.0101	0.0000	16.7153	16.7153	5.4100e-003	0.0000	16.8505
Total	0.0204	0.2121	0.1076	1.9000e-004	0.0903	0.0110	0.1013	0.0497	0.0101	0.0598	0.0000	16.7153	16.7153	5.4100e-003	0.0000	16.8505

Unmitigated Construction Off-Site

	ROG	NOx	CO	SO2	Fugitive PM10	Exhaust PM10	PM10 Total	Fugitive PM2.5	Exhaust PM2.5	PM2.5 Total	Bio- CO2	NBio- CO2	Total CO2	CH4	N2O	CO2e
Category	tons/yr										MT/yr					
Hauling	0.0000	0.0000	0.0000	0.0000	0.0000	0.0000	0.0000	0.0000	0.0000	0.0000	0.0000	0.0000	0.0000	0.0000	0.0000	0.0000
Vendor	0.0000	0.0000	0.0000	0.0000	0.0000	0.0000	0.0000	0.0000	0.0000	0.0000	0.0000	0.0000	0.0000	0.0000	0.0000	0.0000
Worker	3.1000e-004	2.2000e-004	2.3400e-003	1.0000e-005	7.1000e-004	0.0000	7.1000e-004	1.9000e-004	0.0000	1.9000e-004	0.0000	0.6100	0.6100	2.0000e-005	0.0000	0.6104
Total	3.1000e-004	2.2000e-004	2.3400e-003	1.0000e-005	7.1000e-004	0.0000	7.1000e-004	1.9000e-004	0.0000	1.9000e-004	0.0000	0.6100	0.6100	2.0000e-005	0.0000	0.6104

Baseline Storage - Placer County APCD Air District, Annual

3.2 Site Preparation - 2020

Mitigated Construction On-Site

	ROG	NOx	CO	SO2	Fugitive PM10	Exhaust PM10	PM10 Total	Fugitive PM2.5	Exhaust PM2.5	PM2.5 Total	Bio- CO2	NBio- CO2	Total CO2	CH4	N2O	CO2e
Category	tons/yr										MT/yr					
Fugitive Dust					0.0903	0.0000	0.0903	0.0497	0.0000	0.0497	0.0000	0.0000	0.0000	0.0000	0.0000	0.0000
Off-Road	0.0204	0.2121	0.1076	1.9000e-004		0.0110	0.0110		0.0101	0.0101	0.0000	16.7153	16.7153	5.4100e-003	0.0000	16.8505
Total	0.0204	0.2121	0.1076	1.9000e-004	0.0903	0.0110	0.1013	0.0497	0.0101	0.0598	0.0000	16.7153	16.7153	5.4100e-003	0.0000	16.8505

Mitigated Construction Off-Site

	ROG	NOx	CO	SO2	Fugitive PM10	Exhaust PM10	PM10 Total	Fugitive PM2.5	Exhaust PM2.5	PM2.5 Total	Bio- CO2	NBio- CO2	Total CO2	CH4	N2O	CO2e
Category	tons/yr										MT/yr					
Hauling	0.0000	0.0000	0.0000	0.0000	0.0000	0.0000	0.0000	0.0000	0.0000	0.0000	0.0000	0.0000	0.0000	0.0000	0.0000	0.0000
Vendor	0.0000	0.0000	0.0000	0.0000	0.0000	0.0000	0.0000	0.0000	0.0000	0.0000	0.0000	0.0000	0.0000	0.0000	0.0000	0.0000
Worker	3.1000e-004	2.2000e-004	2.3400e-003	1.0000e-005	7.1000e-004	0.0000	7.1000e-004	1.9000e-004	0.0000	1.9000e-004	0.0000	0.6100	0.6100	2.0000e-005	0.0000	0.6104
Total	3.1000e-004	2.2000e-004	2.3400e-003	1.0000e-005	7.1000e-004	0.0000	7.1000e-004	1.9000e-004	0.0000	1.9000e-004	0.0000	0.6100	0.6100	2.0000e-005	0.0000	0.6104

Baseline Storage - Placer County APCD Air District, Annual

3.3 Grading - 2020

Unmitigated Construction On-Site

	ROG	NOx	CO	SO2	Fugitive PM10	Exhaust PM10	PM10 Total	Fugitive PM2.5	Exhaust PM2.5	PM2.5 Total	Bio- CO2	NBio- CO2	Total CO2	CH4	N2O	CO2e
Category	tons/yr										MT/yr					
Fugitive Dust					0.0655	0.0000	0.0655	0.0337	0.0000	0.0337	0.0000	0.0000	0.0000	0.0000	0.0000	0.0000
Off-Road	0.0243	0.2639	0.1605	3.0000e-004		0.0127	0.0127		0.0117	0.0117	0.0000	26.0588	26.0588	8.4300e-003	0.0000	26.2694
Total	0.0243	0.2639	0.1605	3.0000e-004	0.0655	0.0127	0.0783	0.0337	0.0117	0.0454	0.0000	26.0588	26.0588	8.4300e-003	0.0000	26.2694

Unmitigated Construction Off-Site

	ROG	NOx	CO	SO2	Fugitive PM10	Exhaust PM10	PM10 Total	Fugitive PM2.5	Exhaust PM2.5	PM2.5 Total	Bio- CO2	NBio- CO2	Total CO2	CH4	N2O	CO2e
Category	tons/yr										MT/yr					
Hauling	0.0000	0.0000	0.0000	0.0000	0.0000	0.0000	0.0000	0.0000	0.0000	0.0000	0.0000	0.0000	0.0000	0.0000	0.0000	0.0000
Vendor	0.0000	0.0000	0.0000	0.0000	0.0000	0.0000	0.0000	0.0000	0.0000	0.0000	0.0000	0.0000	0.0000	0.0000	0.0000	0.0000
Worker	5.2000e-004	3.6000e-004	3.8900e-003	1.0000e-005	1.1800e-003	1.0000e-005	1.1900e-003	3.1000e-004	1.0000e-005	3.2000e-004	0.0000	1.0167	1.0167	3.0000e-005	0.0000	1.0173
Total	5.2000e-004	3.6000e-004	3.8900e-003	1.0000e-005	1.1800e-003	1.0000e-005	1.1900e-003	3.1000e-004	1.0000e-005	3.2000e-004	0.0000	1.0167	1.0167	3.0000e-005	0.0000	1.0173

Baseline Storage - Placer County APCD Air District, Annual

3.3 Grading - 2020

Mitigated Construction On-Site

	ROG	NOx	CO	SO2	Fugitive PM10	Exhaust PM10	PM10 Total	Fugitive PM2.5	Exhaust PM2.5	PM2.5 Total	Bio- CO2	NBio- CO2	Total CO2	CH4	N2O	CO2e
Category	tons/yr										MT/yr					
Fugitive Dust					0.0655	0.0000	0.0655	0.0337	0.0000	0.0337	0.0000	0.0000	0.0000	0.0000	0.0000	0.0000
Off-Road	0.0243	0.2639	0.1605	3.0000e-004		0.0127	0.0127		0.0117	0.0117	0.0000	26.0587	26.0587	8.4300e-003	0.0000	26.2694
Total	0.0243	0.2639	0.1605	3.0000e-004	0.0655	0.0127	0.0783	0.0337	0.0117	0.0454	0.0000	26.0587	26.0587	8.4300e-003	0.0000	26.2694

Mitigated Construction Off-Site

	ROG	NOx	CO	SO2	Fugitive PM10	Exhaust PM10	PM10 Total	Fugitive PM2.5	Exhaust PM2.5	PM2.5 Total	Bio- CO2	NBio- CO2	Total CO2	CH4	N2O	CO2e
Category	tons/yr										MT/yr					
Hauling	0.0000	0.0000	0.0000	0.0000	0.0000	0.0000	0.0000	0.0000	0.0000	0.0000	0.0000	0.0000	0.0000	0.0000	0.0000	0.0000
Vendor	0.0000	0.0000	0.0000	0.0000	0.0000	0.0000	0.0000	0.0000	0.0000	0.0000	0.0000	0.0000	0.0000	0.0000	0.0000	0.0000
Worker	5.2000e-004	3.6000e-004	3.8900e-003	1.0000e-005	1.1800e-003	1.0000e-005	1.1900e-003	3.1000e-004	1.0000e-005	3.2000e-004	0.0000	1.0167	1.0167	3.0000e-005	0.0000	1.0173
Total	5.2000e-004	3.6000e-004	3.8900e-003	1.0000e-005	1.1800e-003	1.0000e-005	1.1900e-003	3.1000e-004	1.0000e-005	3.2000e-004	0.0000	1.0167	1.0167	3.0000e-005	0.0000	1.0173

Baseline Storage - Placer County APCD Air District, Annual

3.4 Building Construction - 2020

Unmitigated Construction On-Site

	ROG	NOx	CO	SO2	Fugitive PM10	Exhaust PM10	PM10 Total	Fugitive PM2.5	Exhaust PM2.5	PM2.5 Total	Bio- CO2	NBio- CO2	Total CO2	CH4	N2O	CO2e
Category	tons/yr										MT/yr					
Off-Road	0.0753	0.6811	0.5981	9.6000e-004		0.0397	0.0397		0.0373	0.0373	0.0000	82.2215	82.2215	0.0201	0.0000	82.7230
Total	0.0753	0.6811	0.5981	9.6000e-004		0.0397	0.0397		0.0373	0.0373	0.0000	82.2215	82.2215	0.0201	0.0000	82.7230

Unmitigated Construction Off-Site

	ROG	NOx	CO	SO2	Fugitive PM10	Exhaust PM10	PM10 Total	Fugitive PM2.5	Exhaust PM2.5	PM2.5 Total	Bio- CO2	NBio- CO2	Total CO2	CH4	N2O	CO2e
Category	tons/yr										MT/yr					
Hauling	0.0000	0.0000	0.0000	0.0000	0.0000	0.0000	0.0000	0.0000	0.0000	0.0000	0.0000	0.0000	0.0000	0.0000	0.0000	0.0000
Vendor	4.9700e-003	0.1605	0.0317	3.9000e-004	8.8100e-003	7.0000e-004	9.5100e-003	2.5500e-003	6.7000e-004	3.2200e-003	0.0000	37.2371	37.2371	1.8200e-003	0.0000	37.2827
Worker	0.0119	8.3400e-003	0.0894	2.6000e-004	0.0270	1.8000e-004	0.0272	7.2000e-003	1.7000e-004	7.3600e-003	0.0000	23.3397	23.3397	5.8000e-004	0.0000	23.3541
Total	0.0169	0.1688	0.1211	6.5000e-004	0.0359	8.8000e-004	0.0367	9.7500e-003	8.4000e-004	0.0106	0.0000	60.5767	60.5767	2.4000e-003	0.0000	60.6367

Baseline Storage - Placer County APCD Air District, Annual

3.4 Building Construction - 2020

Mitigated Construction On-Site

	ROG	NOx	CO	SO2	Fugitive PM10	Exhaust PM10	PM10 Total	Fugitive PM2.5	Exhaust PM2.5	PM2.5 Total	Bio- CO2	NBio- CO2	Total CO2	CH4	N2O	CO2e
Category	tons/yr										MT/yr					
Off-Road	0.0753	0.6811	0.5981	9.6000e-004		0.0397	0.0397		0.0373	0.0373	0.0000	82.2215	82.2215	0.0201	0.0000	82.7229
Total	0.0753	0.6811	0.5981	9.6000e-004		0.0397	0.0397		0.0373	0.0373	0.0000	82.2215	82.2215	0.0201	0.0000	82.7229

Mitigated Construction Off-Site

	ROG	NOx	CO	SO2	Fugitive PM10	Exhaust PM10	PM10 Total	Fugitive PM2.5	Exhaust PM2.5	PM2.5 Total	Bio- CO2	NBio- CO2	Total CO2	CH4	N2O	CO2e
Category	tons/yr										MT/yr					
Hauling	0.0000	0.0000	0.0000	0.0000	0.0000	0.0000	0.0000	0.0000	0.0000	0.0000	0.0000	0.0000	0.0000	0.0000	0.0000	0.0000
Vendor	4.9700e-003	0.1605	0.0317	3.9000e-004	8.8100e-003	7.0000e-004	9.5100e-003	2.5500e-003	6.7000e-004	3.2200e-003	0.0000	37.2371	37.2371	1.8200e-003	0.0000	37.2827
Worker	0.0119	8.3400e-003	0.0894	2.6000e-004	0.0270	1.8000e-004	0.0272	7.2000e-003	1.7000e-004	7.3600e-003	0.0000	23.3397	23.3397	5.8000e-004	0.0000	23.3541
Total	0.0169	0.1688	0.1211	6.5000e-004	0.0359	8.8000e-004	0.0367	9.7500e-003	8.4000e-004	0.0106	0.0000	60.5767	60.5767	2.4000e-003	0.0000	60.6367

Baseline Storage - Placer County APCD Air District, Annual

3.4 Building Construction - 2021

Unmitigated Construction On-Site

	ROG	NOx	CO	SO2	Fugitive PM10	Exhaust PM10	PM10 Total	Fugitive PM2.5	Exhaust PM2.5	PM2.5 Total	Bio- CO2	NBio- CO2	Total CO2	CH4	N2O	CO2e
Category	tons/yr										MT/yr					
Off-Road	0.1511	1.3859	1.3177	2.1400e-003		0.0762	0.0762		0.0717	0.0717	0.0000	184.1516	184.1516	0.0444	0.0000	185.2623
Total	0.1511	1.3859	1.3177	2.1400e-003		0.0762	0.0762		0.0717	0.0717	0.0000	184.1516	184.1516	0.0444	0.0000	185.2623

Unmitigated Construction Off-Site

	ROG	NOx	CO	SO2	Fugitive PM10	Exhaust PM10	PM10 Total	Fugitive PM2.5	Exhaust PM2.5	PM2.5 Total	Bio- CO2	NBio- CO2	Total CO2	CH4	N2O	CO2e
Category	tons/yr										MT/yr					
Hauling	0.0000	0.0000	0.0000	0.0000	0.0000	0.0000	0.0000	0.0000	0.0000	0.0000	0.0000	0.0000	0.0000	0.0000	0.0000	0.0000
Vendor	9.3200e-003	0.3298	0.0630	8.7000e-004	0.0197	7.5000e-004	0.0205	5.7100e-003	7.2000e-004	6.4300e-003	0.0000	82.7288	82.7288	3.8600e-003	0.0000	82.8252
Worker	0.0249	0.0167	0.1831	5.6000e-004	0.0606	3.9000e-004	0.0610	0.0161	3.6000e-004	0.0165	0.0000	50.4289	50.4289	1.1500e-003	0.0000	50.4577
Total	0.0342	0.3465	0.2461	1.4300e-003	0.0803	1.1400e-003	0.0814	0.0218	1.0800e-003	0.0229	0.0000	133.1577	133.1577	5.0100e-003	0.0000	133.2829

Baseline Storage - Placer County APCD Air District, Annual

3.4 Building Construction - 2021

Mitigated Construction On-Site

	ROG	NOx	CO	SO2	Fugitive PM10	Exhaust PM10	PM10 Total	Fugitive PM2.5	Exhaust PM2.5	PM2.5 Total	Bio- CO2	NBio- CO2	Total CO2	CH4	N2O	CO2e
Category	tons/yr										MT/yr					
Off-Road	0.1511	1.3859	1.3177	2.1400e-003		0.0762	0.0762		0.0717	0.0717	0.0000	184.1514	184.1514	0.0444	0.0000	185.2621
Total	0.1511	1.3859	1.3177	2.1400e-003		0.0762	0.0762		0.0717	0.0717	0.0000	184.1514	184.1514	0.0444	0.0000	185.2621

Mitigated Construction Off-Site

	ROG	NOx	CO	SO2	Fugitive PM10	Exhaust PM10	PM10 Total	Fugitive PM2.5	Exhaust PM2.5	PM2.5 Total	Bio- CO2	NBio- CO2	Total CO2	CH4	N2O	CO2e
Category	tons/yr										MT/yr					
Hauling	0.0000	0.0000	0.0000	0.0000	0.0000	0.0000	0.0000	0.0000	0.0000	0.0000	0.0000	0.0000	0.0000	0.0000	0.0000	0.0000
Vendor	9.3200e-003	0.3298	0.0630	8.7000e-004	0.0197	7.5000e-004	0.0205	5.7100e-003	7.2000e-004	6.4300e-003	0.0000	82.7288	82.7288	3.8600e-003	0.0000	82.8252
Worker	0.0249	0.0167	0.1831	5.6000e-004	0.0606	3.9000e-004	0.0610	0.0161	3.6000e-004	0.0165	0.0000	50.4289	50.4289	1.1500e-003	0.0000	50.4577
Total	0.0342	0.3465	0.2461	1.4300e-003	0.0803	1.1400e-003	0.0814	0.0218	1.0800e-003	0.0229	0.0000	133.1577	133.1577	5.0100e-003	0.0000	133.2829

Baseline Storage - Placer County APCD Air District, Annual

3.5 Paving - 2021

Unmitigated Construction On-Site

	ROG	NOx	CO	SO2	Fugitive PM10	Exhaust PM10	PM10 Total	Fugitive PM2.5	Exhaust PM2.5	PM2.5 Total	Bio- CO2	NBio- CO2	Total CO2	CH4	N2O	CO2e
Category	tons/yr										MT/yr					
Off-Road	0.0126	0.1292	0.1465	2.3000e-004		6.7800e-003	6.7800e-003		6.2400e-003	6.2400e-003	0.0000	20.0235	20.0235	6.4800e-003	0.0000	20.1854
Paving	0.0000					0.0000	0.0000		0.0000	0.0000	0.0000	0.0000	0.0000	0.0000	0.0000	0.0000
Total	0.0126	0.1292	0.1465	2.3000e-004		6.7800e-003	6.7800e-003		6.2400e-003	6.2400e-003	0.0000	20.0235	20.0235	6.4800e-003	0.0000	20.1854

Unmitigated Construction Off-Site

	ROG	NOx	CO	SO2	Fugitive PM10	Exhaust PM10	PM10 Total	Fugitive PM2.5	Exhaust PM2.5	PM2.5 Total	Bio- CO2	NBio- CO2	Total CO2	CH4	N2O	CO2e
Category	tons/yr										MT/yr					
Hauling	0.0000	0.0000	0.0000	0.0000	0.0000	0.0000	0.0000	0.0000	0.0000	0.0000	0.0000	0.0000	0.0000	0.0000	0.0000	0.0000
Vendor	0.0000	0.0000	0.0000	0.0000	0.0000	0.0000	0.0000	0.0000	0.0000	0.0000	0.0000	0.0000	0.0000	0.0000	0.0000	0.0000
Worker	4.8000e-004	3.3000e-004	3.5600e-003	1.0000e-005	1.1800e-003	1.0000e-005	1.1900e-003	3.1000e-004	1.0000e-005	3.2000e-004	0.0000	0.9809	0.9809	2.0000e-005	0.0000	0.9815
Total	4.8000e-004	3.3000e-004	3.5600e-003	1.0000e-005	1.1800e-003	1.0000e-005	1.1900e-003	3.1000e-004	1.0000e-005	3.2000e-004	0.0000	0.9809	0.9809	2.0000e-005	0.0000	0.9815

Baseline Storage - Placer County APCD Air District, Annual

3.5 Paving - 2021

Mitigated Construction On-Site

	ROG	NOx	CO	SO2	Fugitive PM10	Exhaust PM10	PM10 Total	Fugitive PM2.5	Exhaust PM2.5	PM2.5 Total	Bio- CO2	NBio- CO2	Total CO2	CH4	N2O	CO2e
Category	tons/yr										MT/yr					
Off-Road	0.0126	0.1292	0.1465	2.3000e-004		6.7800e-003	6.7800e-003		6.2400e-003	6.2400e-003	0.0000	20.0235	20.0235	6.4800e-003	0.0000	20.1854
Paving	0.0000					0.0000	0.0000		0.0000	0.0000	0.0000	0.0000	0.0000	0.0000	0.0000	0.0000
Total	0.0126	0.1292	0.1465	2.3000e-004		6.7800e-003	6.7800e-003		6.2400e-003	6.2400e-003	0.0000	20.0235	20.0235	6.4800e-003	0.0000	20.1854

Mitigated Construction Off-Site

	ROG	NOx	CO	SO2	Fugitive PM10	Exhaust PM10	PM10 Total	Fugitive PM2.5	Exhaust PM2.5	PM2.5 Total	Bio- CO2	NBio- CO2	Total CO2	CH4	N2O	CO2e
Category	tons/yr										MT/yr					
Hauling	0.0000	0.0000	0.0000	0.0000	0.0000	0.0000	0.0000	0.0000	0.0000	0.0000	0.0000	0.0000	0.0000	0.0000	0.0000	0.0000
Vendor	0.0000	0.0000	0.0000	0.0000	0.0000	0.0000	0.0000	0.0000	0.0000	0.0000	0.0000	0.0000	0.0000	0.0000	0.0000	0.0000
Worker	4.8000e-004	3.3000e-004	3.5600e-003	1.0000e-005	1.1800e-003	1.0000e-005	1.1900e-003	3.1000e-004	1.0000e-005	3.2000e-004	0.0000	0.9809	0.9809	2.0000e-005	0.0000	0.9815
Total	4.8000e-004	3.3000e-004	3.5600e-003	1.0000e-005	1.1800e-003	1.0000e-005	1.1900e-003	3.1000e-004	1.0000e-005	3.2000e-004	0.0000	0.9809	0.9809	2.0000e-005	0.0000	0.9815

Baseline Storage - Placer County APCD Air District, Annual

3.6 Architectural Coating - 2021

Unmitigated Construction On-Site

	ROG	NOx	CO	SO2	Fugitive PM10	Exhaust PM10	PM10 Total	Fugitive PM2.5	Exhaust PM2.5	PM2.5 Total	Bio- CO2	NBio- CO2	Total CO2	CH4	N2O	CO2e
Category	tons/yr										MT/yr					
Archit. Coating	0.3332					0.0000	0.0000		0.0000	0.0000	0.0000	0.0000	0.0000	0.0000	0.0000	0.0000
Off-Road	2.1900e-003	0.0153	0.0182	3.0000e-005		9.4000e-004	9.4000e-004		9.4000e-004	9.4000e-004	0.0000	2.5533	2.5533	1.8000e-004	0.0000	2.5576
Total	0.3354	0.0153	0.0182	3.0000e-005		9.4000e-004	9.4000e-004		9.4000e-004	9.4000e-004	0.0000	2.5533	2.5533	1.8000e-004	0.0000	2.5576

Unmitigated Construction Off-Site

	ROG	NOx	CO	SO2	Fugitive PM10	Exhaust PM10	PM10 Total	Fugitive PM2.5	Exhaust PM2.5	PM2.5 Total	Bio- CO2	NBio- CO2	Total CO2	CH4	N2O	CO2e
Category	tons/yr										MT/yr					
Hauling	0.0000	0.0000	0.0000	0.0000	0.0000	0.0000	0.0000	0.0000	0.0000	0.0000	0.0000	0.0000	0.0000	0.0000	0.0000	0.0000
Vendor	0.0000	0.0000	0.0000	0.0000	0.0000	0.0000	0.0000	0.0000	0.0000	0.0000	0.0000	0.0000	0.0000	0.0000	0.0000	0.0000
Worker	6.1000e-004	4.1000e-004	4.5100e-003	1.0000e-005	1.4900e-003	1.0000e-005	1.5000e-003	4.0000e-004	1.0000e-005	4.1000e-004	0.0000	1.2425	1.2425	3.0000e-005	0.0000	1.2432
Total	6.1000e-004	4.1000e-004	4.5100e-003	1.0000e-005	1.4900e-003	1.0000e-005	1.5000e-003	4.0000e-004	1.0000e-005	4.1000e-004	0.0000	1.2425	1.2425	3.0000e-005	0.0000	1.2432

Baseline Storage - Placer County APCD Air District, Annual

3.6 Architectural Coating - 2021

Mitigated Construction On-Site

	ROG	NOx	CO	SO2	Fugitive PM10	Exhaust PM10	PM10 Total	Fugitive PM2.5	Exhaust PM2.5	PM2.5 Total	Bio- CO2	NBio- CO2	Total CO2	CH4	N2O	CO2e
Category	tons/yr										MT/yr					
Archit. Coating	0.3332					0.0000	0.0000		0.0000	0.0000	0.0000	0.0000	0.0000	0.0000	0.0000	0.0000
Off-Road	2.1900e-003	0.0153	0.0182	3.0000e-005		9.4000e-004	9.4000e-004		9.4000e-004	9.4000e-004	0.0000	2.5533	2.5533	1.8000e-004	0.0000	2.5576
Total	0.3354	0.0153	0.0182	3.0000e-005		9.4000e-004	9.4000e-004		9.4000e-004	9.4000e-004	0.0000	2.5533	2.5533	1.8000e-004	0.0000	2.5576

Mitigated Construction Off-Site

	ROG	NOx	CO	SO2	Fugitive PM10	Exhaust PM10	PM10 Total	Fugitive PM2.5	Exhaust PM2.5	PM2.5 Total	Bio- CO2	NBio- CO2	Total CO2	CH4	N2O	CO2e
Category	tons/yr										MT/yr					
Hauling	0.0000	0.0000	0.0000	0.0000	0.0000	0.0000	0.0000	0.0000	0.0000	0.0000	0.0000	0.0000	0.0000	0.0000	0.0000	0.0000
Vendor	0.0000	0.0000	0.0000	0.0000	0.0000	0.0000	0.0000	0.0000	0.0000	0.0000	0.0000	0.0000	0.0000	0.0000	0.0000	0.0000
Worker	6.1000e-004	4.1000e-004	4.5100e-003	1.0000e-005	1.4900e-003	1.0000e-005	1.5000e-003	4.0000e-004	1.0000e-005	4.1000e-004	0.0000	1.2425	1.2425	3.0000e-005	0.0000	1.2432
Total	6.1000e-004	4.1000e-004	4.5100e-003	1.0000e-005	1.4900e-003	1.0000e-005	1.5000e-003	4.0000e-004	1.0000e-005	4.1000e-004	0.0000	1.2425	1.2425	3.0000e-005	0.0000	1.2432

4.0 Operational Detail - Mobile

Baseline Storage - Placer County APCD Air District, Annual

4.1 Mitigation Measures Mobile

	ROG	NOx	CO	SO2	Fugitive PM10	Exhaust PM10	PM10 Total	Fugitive PM2.5	Exhaust PM2.5	PM2.5 Total	Bio- CO2	NBio- CO2	Total CO2	CH4	N2O	CO2e
Category	tons/yr										MT/yr					
Mitigated	0.1065	0.7717	1.2523	5.0400e-003	0.3829	4.2600e-003	0.3871	0.1030	4.0100e-003	0.1070	0.0000	463.8779	463.8779	0.0173	0.0000	464.3111
Unmitigated	0.1065	0.7717	1.2523	5.0400e-003	0.3829	4.2600e-003	0.3871	0.1030	4.0100e-003	0.1070	0.0000	463.8779	463.8779	0.0173	0.0000	464.3111

4.2 Trip Summary Information

Land Use	Average Daily Trip Rate			Unmitigated	Mitigated
	Weekday	Saturday	Sunday	Annual VMT	Annual VMT
General Light Industry	466.99	88.44	45.56	1,029,732	1,029,732
Other Non-Asphalt Surfaces	0.00	0.00	0.00		
Total	466.99	88.44	45.56	1,029,732	1,029,732

4.3 Trip Type Information

Land Use	Miles			Trip %			Trip Purpose %		
	H-W or C-W	H-S or C-C	H-O or C-NW	H-W or C-W	H-S or C-C	H-O or C-NW	Primary	Diverted	Pass-by
General Light Industry	9.50	7.30	7.30	59.00	28.00	13.00	92	5	3
Other Non-Asphalt Surfaces	9.50	7.30	7.30	0.00	0.00	0.00	0	0	0

4.4 Fleet Mix

Baseline Storage - Placer County APCD Air District, Annual

Land Use	LDA	LDT1	LDT2	MDV	LHD1	LHD2	MHD	HHD	OBUS	UBUS	MCY	SBUS	MH
General Light Industry	0.499712	0.039404	0.220288	0.124864	0.021993	0.006021	0.030614	0.046741	0.001428	0.001188	0.005840	0.000765	0.001142
Other Non-Asphalt Surfaces	0.499712	0.039404	0.220288	0.124864	0.021993	0.006021	0.030614	0.046741	0.001428	0.001188	0.005840	0.000765	0.001142

5.0 Energy Detail

Historical Energy Use: N

5.1 Mitigation Measures Energy

Category	ROG	NOx	CO	SO2	Fugitive PM10	Exhaust PM10	PM10 Total	Fugitive PM2.5	Exhaust PM2.5	PM2.5 Total	Bio- CO2	NBio- CO2	Total CO2	CH4	N2O	CO2e
	tons/yr										MT/yr					
Electricity Mitigated						0.0000	0.0000		0.0000	0.0000	0.0000	203.8489	203.8489	7.4500e-003	1.5400e-003	204.4942
Electricity Unmitigated						0.0000	0.0000		0.0000	0.0000	0.0000	203.8489	203.8489	7.4500e-003	1.5400e-003	204.4942
NaturalGas Mitigated	6.7300e-003	0.0612	0.0514	3.7000e-004		4.6500e-003	4.6500e-003		4.6500e-003	4.6500e-003	0.0000	66.6450	66.6450	1.2800e-003	1.2200e-003	67.0410
NaturalGas Unmitigated	6.7300e-003	0.0612	0.0514	3.7000e-004		4.6500e-003	4.6500e-003		4.6500e-003	4.6500e-003	0.0000	66.6450	66.6450	1.2800e-003	1.2200e-003	67.0410

Baseline Storage - Placer County APCD Air District, Annual

5.2 Energy by Land Use - Natural Gas

Unmitigated

	Natural Gas Use	ROG	NOx	CO	SO2	Fugitive PM10	Exhaust PM10	PM10 Total	Fugitive PM2.5	Exhaust PM2.5	PM2.5 Total	Bio- CO2	NBio- CO2	Total CO2	CH4	N2O	CO2e
Land Use	kBTU/yr	tons/yr										MT/yr					
General Light Industry	1.24888e+006	6.7300e-003	0.0612	0.0514	3.7000e-004		4.6500e-003	4.6500e-003		4.6500e-003	4.6500e-003	0.0000	66.6450	66.6450	1.2800e-003	1.2200e-003	67.0410
Other Non-Asphalt Surfaces	0	0.0000	0.0000	0.0000	0.0000		0.0000	0.0000		0.0000	0.0000	0.0000	0.0000	0.0000	0.0000	0.0000	0.0000
Total		6.7300e-003	0.0612	0.0514	3.7000e-004		4.6500e-003	4.6500e-003		4.6500e-003	4.6500e-003	0.0000	66.6450	66.6450	1.2800e-003	1.2200e-003	67.0410

Mitigated

	Natural Gas Use	ROG	NOx	CO	SO2	Fugitive PM10	Exhaust PM10	PM10 Total	Fugitive PM2.5	Exhaust PM2.5	PM2.5 Total	Bio- CO2	NBio- CO2	Total CO2	CH4	N2O	CO2e
Land Use	kBTU/yr	tons/yr										MT/yr					
General Light Industry	1.24888e+006	6.7300e-003	0.0612	0.0514	3.7000e-004		4.6500e-003	4.6500e-003		4.6500e-003	4.6500e-003	0.0000	66.6450	66.6450	1.2800e-003	1.2200e-003	67.0410
Other Non-Asphalt Surfaces	0	0.0000	0.0000	0.0000	0.0000		0.0000	0.0000		0.0000	0.0000	0.0000	0.0000	0.0000	0.0000	0.0000	0.0000
Total		6.7300e-003	0.0612	0.0514	3.7000e-004		4.6500e-003	4.6500e-003		4.6500e-003	4.6500e-003	0.0000	66.6450	66.6450	1.2800e-003	1.2200e-003	67.0410

Baseline Storage - Placer County APCD Air District, Annual

5.3 Energy by Land Use - Electricity

Unmitigated

	Electricity Use	Total CO2	CH4	N2O	CO2e
Land Use	kWh/yr	MT/yr			
General Light Industry	566150	203.8489	7.4500e-003	1.5400e-003	204.4942
Other Non-Asphalt Surfaces	0	0.0000	0.0000	0.0000	0.0000
Total		203.8489	7.4500e-003	1.5400e-003	204.4942

Mitigated

	Electricity Use	Total CO2	CH4	N2O	CO2e
Land Use	kWh/yr	MT/yr			
General Light Industry	566150	203.8489	7.4500e-003	1.5400e-003	204.4942
Other Non-Asphalt Surfaces	0	0.0000	0.0000	0.0000	0.0000
Total		203.8489	7.4500e-003	1.5400e-003	204.4942

6.0 Area Detail

6.1 Mitigation Measures Area

Baseline Storage - Placer County APCD Air District, Annual

	ROG	NOx	CO	SO2	Fugitive PM10	Exhaust PM10	PM10 Total	Fugitive PM2.5	Exhaust PM2.5	PM2.5 Total	Bio- CO2	NBio- CO2	Total CO2	CH4	N2O	CO2e
Category	tons/yr										MT/yr					
Mitigated	0.3057	2.0000e-005	2.1200e-003	0.0000		1.0000e-005	1.0000e-005		1.0000e-005	1.0000e-005	0.0000	4.1100e-003	4.1100e-003	1.0000e-005	0.0000	4.3800e-003
Unmitigated	0.3057	2.0000e-005	2.1200e-003	0.0000		1.0000e-005	1.0000e-005		1.0000e-005	1.0000e-005	0.0000	4.1100e-003	4.1100e-003	1.0000e-005	0.0000	4.3800e-003

6.2 Area by SubCategory

Unmitigated

	ROG	NOx	CO	SO2	Fugitive PM10	Exhaust PM10	PM10 Total	Fugitive PM2.5	Exhaust PM2.5	PM2.5 Total	Bio- CO2	NBio- CO2	Total CO2	CH4	N2O	CO2e
SubCategory	tons/yr										MT/yr					
Architectural Coating	0.0333					0.0000	0.0000		0.0000	0.0000	0.0000	0.0000	0.0000	0.0000	0.0000	0.0000
Consumer Products	0.2722					0.0000	0.0000		0.0000	0.0000	0.0000	0.0000	0.0000	0.0000	0.0000	0.0000
Landscaping	2.0000e-004	2.0000e-005	2.1200e-003	0.0000		1.0000e-005	1.0000e-005		1.0000e-005	1.0000e-005	0.0000	4.1100e-003	4.1100e-003	1.0000e-005	0.0000	4.3800e-003
Total	0.3057	2.0000e-005	2.1200e-003	0.0000		1.0000e-005	1.0000e-005		1.0000e-005	1.0000e-005	0.0000	4.1100e-003	4.1100e-003	1.0000e-005	0.0000	4.3800e-003

Baseline Storage - Placer County APCD Air District, Annual

6.2 Area by SubCategory

Mitigated

	ROG	NOx	CO	SO2	Fugitive PM10	Exhaust PM10	PM10 Total	Fugitive PM2.5	Exhaust PM2.5	PM2.5 Total	Bio- CO2	NBio- CO2	Total CO2	CH4	N2O	CO2e
SubCategory	tons/yr										MT/yr					
Architectural Coating	0.0333					0.0000	0.0000		0.0000	0.0000	0.0000	0.0000	0.0000	0.0000	0.0000	0.0000
Consumer Products	0.2722					0.0000	0.0000		0.0000	0.0000	0.0000	0.0000	0.0000	0.0000	0.0000	0.0000
Landscaping	2.0000e-004	2.0000e-005	2.1200e-003	0.0000		1.0000e-005	1.0000e-005		1.0000e-005	1.0000e-005	0.0000	4.1100e-003	4.1100e-003	1.0000e-005	0.0000	4.3800e-003
Total	0.3057	2.0000e-005	2.1200e-003	0.0000		1.0000e-005	1.0000e-005		1.0000e-005	1.0000e-005	0.0000	4.1100e-003	4.1100e-003	1.0000e-005	0.0000	4.3800e-003

7.0 Water Detail

7.1 Mitigation Measures Water

Baseline Storage - Placer County APCD Air District, Annual

	Total CO2	CH4	N2O	CO2e
Category	MT/yr			
Mitigated	35.1018	0.5060	0.0122	51.3714
Unmitigated	35.1018	0.5060	0.0122	51.3714

7.2 Water by Land Use

Unmitigated

	Indoor/Outdoor Use	Total CO2	CH4	N2O	CO2e
Land Use	Mgal	MT/yr			
General Light Industry	15.4938 / 0	35.1018	0.5060	0.0122	51.3714
Other Non-Asphalt Surfaces	0 / 0	0.0000	0.0000	0.0000	0.0000
Total		35.1018	0.5060	0.0122	51.3714

Baseline Storage - Placer County APCD Air District, Annual

7.2 Water by Land Use

Mitigated

	Indoor/Outdoor Use	Total CO2	CH4	N2O	CO2e
Land Use	Mgal	MT/yr			
General Light Industry	15.4938 / 0	35.1018	0.5060	0.0122	51.3714
Other Non-Asphalt Surfaces	0 / 0	0.0000	0.0000	0.0000	0.0000
Total		35.1018	0.5060	0.0122	51.3714

8.0 Waste Detail

8.1 Mitigation Measures Waste

Category/Year

	Total CO2	CH4	N2O	CO2e
	MT/yr			
Mitigated	16.8645	0.9967	0.0000	41.7811
Unmitigated	16.8645	0.9967	0.0000	41.7811

Baseline Storage - Placer County APCD Air District, Annual

8.2 Waste by Land Use

Unmitigated

	Waste Disposed	Total CO2	CH4	N2O	CO2e
Land Use	tons	MT/yr			
General Light Industry	83.08	16.8645	0.9967	0.0000	41.7811
Other Non-Asphalt Surfaces	0	0.0000	0.0000	0.0000	0.0000
Total		16.8645	0.9967	0.0000	41.7811

Mitigated

	Waste Disposed	Total CO2	CH4	N2O	CO2e
Land Use	tons	MT/yr			
General Light Industry	83.08	16.8645	0.9967	0.0000	41.7811
Other Non-Asphalt Surfaces	0	0.0000	0.0000	0.0000	0.0000
Total		16.8645	0.9967	0.0000	41.7811

9.0 Operational Offroad

Equipment Type	Number	Hours/Day	Days/Year	Horse Power	Load Factor	Fuel Type
----------------	--------	-----------	-----------	-------------	-------------	-----------

Baseline Storage - Placer County APCD Air District, Annual

10.0 Stationary Equipment

Fire Pumps and Emergency Generators

Equipment Type	Number	Hours/Day	Hours/Year	Horse Power	Load Factor	Fuel Type
----------------	--------	-----------	------------	-------------	-------------	-----------

Boilers

Equipment Type	Number	Heat Input/Day	Heat Input/Year	Boiler Rating	Fuel Type
----------------	--------	----------------	-----------------	---------------	-----------

User Defined Equipment

Equipment Type	Number
----------------	--------

11.0 Vegetation

TABLE OF APPLICABLE MITIGATION MEASURES

Mitigation Measure	Implementation	Timing	Reviewing Party	Documents to be Submitted to City	Staff Use Only
<p>MM 4.4-1 Dust and Construction Control Measures</p> <p>In accordance with the PCAPCD, the applicant shall comply with all applicable rules and regulations as listed above (e.g., Rule 202, 218 and 228). In addition, at the time of tentative map the applicant(s) shall implement a minimum of five (5) of the following measures unless superseded by state or other more stringent standards:</p> <p>The following mitigation measures shall be implemented to reduce short-term construction-related air quality impacts. In addition, dust control measures are required to be implemented by all projects in accordance with the City of Roseville Grading Ordinance, and the PCAPCD Fugitive Dust Rule 228.</p> <ul style="list-style-type: none"> Applicant shall submit to PCAPCD a Construction Emission / Dust Control Plan within 30 days prior to groundbreaking. If the PCAPCD does not respond within 20 days, the plan shall be considered approved. The plan must address the minimum requirements found in section 300 and 400 of District Rule 228, Fugitive Dust (www.placer.ca.gov/airpollution/airpolut.htm). The applicant shall keep a hard or electronic copy of Rule 228, Fugitive Dust on-site for reference. The Construction Emission/Dust Control Plan shall include a comprehensive inventory (i.e. make, model, year, emission rating) of all heavy-duty off-road equipment (50 horsepower (HP) or greater) that will be used an aggregate of 40 or more hours for the construction project. If any new equipment is added after submission of the inventory, the prime contractor shall the prime contractor shall contact the APCD prior to the new equipment being utilized. The project representative shall provide PCAPCD with the anticipated construction timeline including start date, and name and phone number of the project manager and on-site foreman. The plan shall demonstrate that the heavy-duty (> 50 HP) off-road vehicles to be used in the construction project, including owned, leased and subcontractor vehicles, will achieve a project wide fleet-average 20% NO_x reduction and 45% particulate reduction compared to the most recent ARB fleet average. PCAPCD shall be contacted for average fleet emission data. Acceptable options for reducing emissions may include use of late model engines, low-emission diesel products, alternative fuels, engine retrofit technology, after-treatment products, and/or other options as they become available. Contractors can access the Sacramento Metropolitan Air Quality Management District's web site to determine if their off-road fleet meets the requirements listed in this measure (http://www.airquality.org/ceqa/Construction_Mitigation_Calculator.xls). <p>The following measures are also included to reduce construction-related ROG, NO_x, PM10 and PM2.5 emissions:</p> <ul style="list-style-type: none"> All construction equipment shall be maintained in good operating condition. Contractor shall ensure that all construction equipment is being properly serviced and maintained as per the manufacturer's specifications. Maintenance records shall be available at the construction site for verification. This measure will reduce combustion emissions of all criteria air pollutants. Prior to the issuance of any grading permits, all applicants shall submit construction plans denoting the proposed schedule and projected equipment use. Construction contractors shall provide evidence that low emission mobile construction will be used, or that their use was investigated and found to be infeasible for the project. Low emission equipment is defined as meeting the California Air Resources Board's Tier III standards. Contractors shall also conform to any construction measures imposed by the PCAPCD as well as City Planning Staff. This measure will primarily reduce ROG, NO_x, PM10, and PM2.5 exhaust emissions. Paints and coating shall be applied either by hand or by high volume, low-pressure spray. This measure will reduce evaporative ROG emissions. All construction shall comply with the following measures to reduce fugitive dust related emissions of PM10 and PM2.5: <ul style="list-style-type: none"> Maintain a minimum 24-inch freeboard on soil haul trucks or cover payloads using tarps or other suitable means. Suspend grading operations during high winds (greater than 15 mph). Sweep streets as necessary if silt is carried off-site to adjacent public thoroughfares or occurs as a result of hauling. 	<p>The applicants shall submit construction management plans as part of the Grading Permit application.</p> <p>Engineering will review plans for inclusion of these measures prior to issuance of permits or approval of plans.</p>	<p><i>Pre-Construction:</i> Prior to issuance of Grading Permits or Improvement Plans.</p> <p>Add as note on Improvement Plans.</p>	<p>Engineering</p>	<p>Dust Control Plan and proof of submittal to PCAPCD</p>	

<ul style="list-style-type: none"> ○ Dispose of surplus excavated material in accordance with local ordinances and use sound engineering practices. ○ Schedule activities to minimize the amounts of exposed excavated soil during and after the end of work periods. ○ Phase grading into smaller areas to prevent the susceptibility of larger areas to erosion over extended periods of time. ○ Pave or apply gravel to any on-site haul roads. ○ Reestablish ground cover on the construction site through seeding and water. ○ Clean earth moving construction equipment with water or sweep clean, once per day, or as necessary (e.g., when moving onsite), consistent with National Pollutant Discharge Elimination System Best Management Practices and the Roseville Grading Ordinance. Water shall be applied to control dust as needed to prevent dust impacts offsite. Operational water truck(s), shall be on-site, as required, to control fugitive dust. Construction vehicles leaving the site shall be cleaned, as needed, to prevent dust, silt, mud, and dirt from being released or tracked off-site. ○ Spread soil binders on unpaved roads and employee/equipment parking areas. Soil binders shall be non-toxic in accordance with state and local regulations. Apply approved chemical soil stabilizers, or vegetated mats, etc. according to manufacturers' specifications, to all-inactive construction areas (previously graded areas which remain inactive for 96 hours). ○ Minimize diesel idling time to a maximum of five minutes. ○ Utilize existing power sources (e.g., power poles) or clean fuel generators rather than temporary diesel power generators, if feasible. ○ An applicant representative, ARB-certified to perform Visible Emissions Evaluations (VEE), shall routinely (i.e., once per week) evaluate project related off-road and heavy-duty on-road equipment emissions for compliance with this requirement for projects grading more than 20 acres in size, regardless of how many acres are to be disturbed daily. ○ Construction equipment exhaust emissions shall not exceed the PCAPCD Visible Emissions Rule 202. Fugitive dust is not to exceed 40% opacity and not go beyond property boundary at any time. Operators of vehicles and equipment found to exceed opacity limits are to be immediately notified and the equipment must be repaired within 72 hours. <p>The following measures will be required:</p> <ol style="list-style-type: none"> 1. Include the following standard note on the Improvement/Grading Plan: <i>If required by the Public Works Department, the contractor shall hold a pre-construction meeting prior to grading activities. The contractor shall invite the Placer County APCD to the pre-construction meeting in order to discuss the construction emission/dust control plan with employees and/or contractors.</i> 2. Prior to building permit approval, the applicant shall show, on the plans submitted to the Building Department, that electrical outlets shall be installed on the exterior walls of both the front and back of all residences or all commercial buildings to promote the use of electric landscape maintenance equipment. 3. Prior to building permit approval, the applicant shall show, on the plans submitted to the Building Department, provisions for construction of new residences, and where natural gas is available, the installation of a gas outlet for use with outdoor cooking appliances, such as a gas barbecue or outdoor recreational fire pits. 4. Prior to building permit approval, in accordance with District Rule 225, only U.S. EPA Phase II certified wood burning devices shall be allowed in single-family residences. The emission potential from each residence shall not exceed a cumulative total of 7.5 grams per hour for all devices. Masonry fireplaces shall have either an EPA certified Phase II wood burning device or shall be a U.L. Listed Decorative Gas Appliance. (Rule 225) 5. Wood burning or Pellet appliances shall not be permitted in multi-family developments. Only natural gas or propane fired fireplace appliances are permitted. These appliances shall be clearly delineated on the Floor Plans submitted in conjunction with the Building Permit application. (Rule 225 / section 302.2) 6. Prior to the issuance of a Building Permit, the applicant shall show that all flat roofs with parapets shall include a white or silver cap sheet to reduce energy demands. 7. Diesel trucks shall be prohibited from idling more than five minutes. Prior to the issuance of a Building Permit, the applicant shall show that all truck loading and unloading docks shall be 					
--	--	--	--	--	--

<p>equipped with one 110/208 volt power outlet for every two dock doors. Diesel Trucks idling for more than five minutes shall be required to connect to the 110/208 volt power to run any auxiliary equipment. 2'x3' signage which indicates "Diesel engine Idling Limited to a Maximum of 5 Minutes" shall be shown on the building elevations and shall be submitted to the Placer County APCD prior to the issuance of Building Permits for the project.</p> <p>8. Prior to approval of Improvement Plans, an enforcement plan shall be established, and submitted to the APCD for review, in order to evaluate project-related on-and-off- road heavy-duty vehicle engine emission opacities on a weekly basis, using standards as defined in California Code of Regulations, Title 13, Sections 2180 – 2194. An Environmental Coordinator, hired by the prime contractor or property owner, and who is CARB-certified to perform Visible Emissions Evaluations (VEE), shall routinely evaluate project related off-road and heavy duty on-road equipment emissions for compliance with this requirement. Operators of vehicles and equipment found to exceed opacity limits will be notified by APCD and the equipment must be repaired within 72 hours. (California Code of Regulations, Title 13, Sections 2180 – 2194)</p> <p><i>The project shall comply with all applicable Placer County Air Pollution Control District rules and regulations, and shall obtain applicable permits and/or clearances from the District prior to the start of construction.</i></p> <ul style="list-style-type: none"> • The contractor shall use CARB ultra-low sulfur diesel fuel for all diesel-powered equipment. In addition, low sulfur fuel shall be utilized for all stationary equipment. (California Standards for Motor Vehicle Diesel Fuel, title 13, article 4.8, chapter 9, California Code of Regulations). • Processes that discharge 2 pounds per day or more of air contaminants, as defined by Health and Safety Code Section 39013, to the atmosphere may require a permit. Permits are required for both construction and operation. Developers/contractors should contact the District prior to construction and obtain any necessary permits prior to the issuance of a Building Permit. (Rule 501) • Pursuant to the Placer County Air Pollution Control District Rule 501, General Permit Requirements, the proposed project may need a permit from the District prior to construction. In general, any engine greater than 50 brake horsepower or any boiler with heat greater than 1,000,000 Btu per hour shall require a permit issued by the District. (Rule 501) • All on-site stationary equipment which is classified as 50 hp or greater shall either obtain a state issued portable equipment permit or a Placer County APCD issued portable equipment permit. (California Portable Equipment Registration Program, Section 2452). • The contractor shall utilize existing power sources (e.g., power poles) or clean fuel generators rather than temporary diesel power generators if feasible. • During construction, the contractor shall minimize idling time to a maximum of 5 minutes for all diesel powered equipment. • During construction, traffic speeds on all unpaved surfaces shall be limited to 15 miles per hour or less. (Rule 228 / section 401.2) 					
<p>MM 4.6-2 & 4.4-1 Commercial Noise Controls</p> <p>For all commercial uses within 150 feet of residential uses, the developer shall implement the following or equally effective measures:</p> <ul style="list-style-type: none"> • In general, where commercial land uses adjoin residential property lines, the following measures should be included in the design of the commercial use. If the primary noise sources are parking lot noise, HVAC equipment and light truck deliveries, then 6-7 foot tall masonry walls shall be constructed to provide adequate isolation of parking lot and delivery truck activities. HVAC equipment shall be located either at ground level, or when located on roof-tops the building facades shall include parapets for shielding. • Where commercial uses adjoin common residential property lines, and loading docks or truck circulation routes face the residential areas, the following mitigation measures shall be included in the project design: <ul style="list-style-type: none"> ○ Loading docks and truck delivery areas shall maintain a minimum distance of 30 feet from residential property lines; ○ Property line barriers shall be 6 to 8 feet in height. Circulation routes for trucks should be located a minimum of 30-feet from residential property lines; 	<p>Project plans will be reviewed for compliance.</p>	<p><i>Pre-Construction:</i> Prior to issuance of Improvement Plans and/or Building Permits Add as note on Improvement Plans and Building Plans</p>	<p>Engineering will review Improvement Plans for compliance with wall requirements. Building will review Building Plans for compliance with HVAC requirements.</p>	<p>Acoustical Study if loading docks or truck delivery routes are less than 100 feet from residential property lines</p>	

<ul style="list-style-type: none"> o All heating, cooling and ventilation equipment shall be located within mechanical rooms where possible; o All heating, cooling and ventilation equipment shall be shielded from view with solid barriers; o Emergency generators shall comply with the local noise criteria at the nearest noise-sensitive receivers; <p>In cases where loading docks or truck delivery circulation routes are located less than 100 feet from residential property lines, an acoustical evaluation shall be submitted to verify compliance with the City of Roseville Noise Level Performance Standards.</p>					
<p>Use Low-Glare Materials for New Development</p> <p>In order to reduce the effects of daytime glare from development of commercial or office uses within the SVSP Area, building developers should make use, when feasible, of low-glare materials.</p> <p>MM 4.14-3 Avoid Light Spill Over into Curry Creek and Open Space Areas</p> <p>Outdoor lighting shall be placed, designed and directed so as to avoid light spillover into the habitat of Curry Creek and the Open Space Preserve areas located immediately adjacent to the open space, as shown on the Land Use Map as parcels KT-1, KT-40, KT-30, KT-41, DF-1, DF-2, DF-40, CG-1, CG-82m JM-21, JM-3, and JM-4.</p>	<p>Comply with the measure</p>	<p><i>Pre-Construction:</i> Ensure fixtures shown on Improvement Plans and Building Plans comply with the measure.</p> <p>Add as note on Improvement Plans and Building Plans</p>	<p>Engineering and Building</p>	<p>None</p>	
<p>MM 4.6-1 Construction Noise Reduction</p> <p>MM 4.6-1(a): Construction activities shall comply with the requirements of the City of Roseville Noise Ordinance.</p> <p>MM4.6-1(b): Locate fixed construction equipment such as compressors and generators as far as possible from sensitive receptors. Shroud or shield all impact tools, and muffle or shield all in-take and exhaust ports on power construction equipment.</p> <p>MM 4.6-1(c): Designate a construction disturbance coordinator and conspicuously post the Coordinator’s contact information around the project site and in adjacent public spaces. The disturbance coordinator will receive all public complaints about construction noise disturbances, and will be responsible for determining the cause of the complaint, and implementing any feasible measures to be taken to alleviate the problem.</p> <p>MM 4.6-1(d): Well drilling shall occur prior to construction of the adjacent subdivision, to the extent feasible. If construction timing for the wells occurs after subdivision construction, then measures to reduce noise shall include; hanging flexible sound control curtains around the drilling apparatus, and the drill rig, to the degree feasible, as determined by the Environmental Utilities Director, if located within 1,000-feet of an occupied residence.</p>	<p>Discuss during pre-construction meeting and comply with the measure.</p>	<p><i>Pre-Construction and Construction:</i> During construction for MM 4.6-1(d), and prior to issuance of Improvement Plans and/or Building Permits for all others.</p> <p>Add as note on Improvement Plans and Building Plans</p>	<p><u>Engineering</u> staff to discuss this measure during pre-construction meeting and ensure posting has occurred.</p> <p><u>Environmental Utilities</u> to address well drilling.</p>	<p>None</p>	
<p>MM 4.8-3 Avoid Nesting Sites</p> <p>To ensure that fully protected bird and raptor species are not injured or disturbed by construction in the vicinity of nesting habitat, the project applicant shall implement the following measures:</p> <p><i>Raptors</i></p> <p>a) When feasible, all tree removal shall occur between August 30th and February 15th to avoid the breeding season of any raptor species that could be using the area, and to discourage hawks from nesting in the vicinity of an upcoming construction area.</p> <p>b) For Swainson’s hawk, if avoidance of tree removal outside the breeding season is not feasible, and a nest is present, the applicants would be required to obtain a 2081 permit from CDFG to mitigate for potential “take” under CESA. If no nesting is occurring, a take permit would not be required.</p> <p>c) Prior to the beginning of mass grading, including grading for major infrastructure improvements, during the period between February 15th and August 30th, all trees and potential burrowing owl habitat within 350 feet of any grading or earthmoving activity shall be surveyed for active raptor nests or burrows by a qualified biologist no more than 30-days prior to disturbance. If active raptor nests or burrows are found, and the site is within 350-feet of potential construction activity, a highly visible temporary fence shall be erected around the tree or burrow(s) at a distance of up to 350-feet, depending on the species, from the edge of the canopy to prevent construction disturbance and intrusions on the nest area.</p> <p>d) Preconstruction and non-breeding season exclusion measures shall be developed in consultation with CDFG, and shall preclude burrowing owl occupation of the portions of the project site subject to disturbance such as grading. Burrowing owls may be passively excluded from burrows in construction areas by placing one-way doors in the burrows according to CDFG protocol. The one-way doors must be in place for a minimum of three days. All burrows that may be occupied</p>	<p>Results of preconstruction surveys shall be submitted prior to the issuance of a grading permit or Improvement Plans. Applicable construction restrictions shall be reflected within plans. The applicants shall prepare annual reports on the status and success of mitigation and shall submit these reports to USFWS and CDFG. The applicants shall coordinate with USFWS and CDFG to modify as necessary any mitigation plans in an effort to attain mitigation success.</p>	<p><i>Pre-Construction and Construction:</i> Surveys required prior to construction. If surveys are positive for birds, then remainder of mitigation steps are required prior to construction.</p> <p>Add as note on Improvement Plans.</p>	<p>Engineering</p>	<p>Nesting bird surveys</p>	

<p>by burrowing owls regardless of whether they exhibit signs of occupation must be cleared with the one way doors. Burrows that have been cleared through the use of the one- way doors shall then be closed or backfilled to prevent owls from entering the burrow.</p> <p>e) No construction vehicles shall be permitted within restricted areas (i.e., raptor protection zones) unless directly related to the management or protection of the legally protected species.</p> <p>f) If a legally protected species nest is located in a tree designated for removal, the removal shall be deferred until after August 30th or until the adults and young of the year are no longer dependent on the nest site as determined by a qualified biologist.</p> <p><i>Black Rails and Tri-colored Blackbirds</i></p> <p>Prior to earth moving that would disturb marsh habitat, a qualified biologist shall conduct surveys to determine the presence of the California black rail. If either of these species is found, all earth moving within 250 feet shall stop and measures, including establishing nest protection buffers along both sides of Curry Creek during the nesting season (generally February 1 through August 31st) shall be implemented.</p> <p><i>Rookeries</i></p> <p>No heron rookeries are present within the plan area. Prior to earthmoving that would disturb marsh habitat or tree removal of the eucalyptus grove, pre-construction surveys should be conducted to verify that no rookeries have been established. If rookeries are present all earth moving within 250-feet shall stop, during the breeding season.</p>					
<p>MM 4.13-1 Implementation of construction activity stormwater protection standards</p> <p>Prior to the issuance of a City grading permit and the commencement of construction activities, compliance with the State's General Construction permit, the City of Roseville's Construction Standards, and the City's Stormwater BMP Guidance Manual will be met. This includes the creation of a Storm Water Pollution Prevention Plan (SWPPP) that will identify the site, the location of sensitive habitats or watercourses, drainage areas, discharge locations, soil disturbance areas, and the locations of all runoff, erosion control, and sediment control Best Management Practices (BMPs). On-going monitoring and adjustments to the SWPPP will occur when needed to address changes in the field as construction activities evolve.</p>	<p>The developer shall create a SWPPP, submit it to the City, and comply with its provisions.</p>	<p><i>Pre-Construction and Construction:</i> Submit SWPPP and ensure that BMPs remain in place during construction.</p> <p>Add as note on Improvement Plans and Building Plans.</p>	<p>Engineering</p>	<p>SWPPP</p>	
<p>MM 4.9-1 Cease Work and Consult with Qualified Archaeologist</p> <p>Should any cultural resources, such as structural features, any amount of bone or shell, artifacts, human remains, or architectural remains, be encountered during any subsurface development activities, work shall be suspended within 100-feet of the find. The City of Roseville Planning and Public Works Staff shall be immediately notified. At that time, the City of Roseville shall coordinate any necessary investigation of the site with qualified archaeologists as needed, to assess the resource (i.e., whether it is an "historical resource" or a "unique archaeological resource") and provide proper management recommendations should potential impacts to the resources be found to be significant. Possible management recommendations for important resources could include resource avoidance or, where avoidance is infeasible in light of project design or layout or is unnecessary to avoid significant effects, data recovery excavations. The contractor shall implement any measures deemed feasible and necessary by City staff, in consultation with the archaeologists, to be to avoid or minimize significant effects to the cultural resources. In addition, pursuant to Section 5097.98 or the State Public Resources Code, and Section 7050.5 of the State Health and Safety Code, in the event of the discovery of human remains, the County Coroner shall be immediately notified. If the remains are determined to be Native American, guidelines of the Native American Heritage Commission shall be adhered to in the treatment and disposition of the remains.</p>	<p>This condition shall be reflected in all construction and building plans, and construction site workers shall be advised by the site manager of this measure.</p>	<p><i>Construction:</i> Measure applies if resources are discovered during construction.</p> <p>Add as note on Improvement Plans and Building Plans.</p>	<p>Engineering and Building</p>	<p>None</p>	
<p>Mitigation Measure 4.9-3 Cease Work and Consult with Qualified Paleontologist</p> <p>Should any evidence of paleontological resources (e.g. fossils) be encountered during grading or excavation, work shall be suspended within 100 feet of the find, and the City of Roseville shall be immediately notified. At that time, the City shall coordinate any necessary investigation of the site with a qualified paleontologist to assess the resource and provide proper management recommendations. Possible management recommendations for important resources could include resource avoidance, if feasible in light of project design or layout, or data recovery excavations. The contractor shall implement any measures deemed feasible and necessary by City staff in consultation with the paleontologist for the protection of the paleontological resources.</p>	<p>This condition shall be reflected in all construction and building plans, and construction site workers shall be advised by the site manager of this measure.</p>	<p><i>Construction:</i> Measure applies if resources are discovered during construction.</p> <p>Add as note on Improvement Plans and Building Plans.</p>	<p>Engineering and Building</p>	<p>None</p>	
<p>MM 4.12.4-2 Divert Construction Debris</p> <p>The applicants shall ensure a 50% reduction in the construction waste stream generated from development within the SVSP. In Developer contracts with construction contractors and their sub-</p>	<p>Comply with the measure</p>	<p><i>Construction:</i> Contractor to ensure diversion occurs during construction.</p>	<p>Environmental Utilities</p>	<p>Records of diversion</p>	

contractors, the Developer shall require that construction waste be reduced by 50%. The Developer shall further require that contractors and sub-contractors submit records of diversion and disposal to the City's Environmental Utilities Department in order to verify compliance with this requirement.		Add as note on Improvement Plans and Building Plans.			
---	--	--	--	--	--

NOTE: This table is provided as a courtesy to the developer, to highlight the text of measures which are required to be placed on Improvement Plans and/or Building Plans. Refer to the applicable environmental document (e.g. Environmental Impact Report) for a full list of measures, and for context. Other measures may be applicable, but are not included here because they have already been completed or they are addressed via other mechanisms (e.g. development fees).